



# UKS

KALIP ELEMANLARI  
MOLD COMPONENTS

The right choice  
of the mold maker



[www.uk.com.tr](http://www.uk.com.tr)

ÜRÜN KATALOĞU  
PRODUCT CATALOGUE



"Bu katalogda yer alan resim, teknik çizim ve açıklamaların her türlü hakkı; 6762 sayılı Türk Ticaret Kanunu, 551 sayılı patent haklarının korunması hakkında KHK, 556 sayılı markaların korunması hakkında KHK, 554 sayılı endüstriyel tasarımların korunması hakkında KHK, 5846 sayılı fikir ve sanat eserleri kanunu vesair yasalar gereğince Uğur Kalıp Pres Elektronik ve Makina Sanayi ve Ticaret Ltd. Şti.'ne aittir. İzinsiz çoğaltılamaz ve kullanılamaz."

*"Entire rights of the pictures, technical drawings and explanations taking place in the catalogue belong to Uğur Kalıp Pres Elektronik ve Makina Sanayi ve Ticaret Ltd. Şti. They can not be reproduced and used without permission"*

Önemli Not: Bu katalogta yer alan resim, teknik çizim ve tipografik hatalardan müessesemiz sorumlu tutulamaz.

UKS Kalıp Elemanları yarım asıra yaklaşan kalıplılık tecrübesini 2004 senesinde kalıp elemanları alanına da aktararak bu alanda faaliyetlerine başlamıştır.

2004 yılından günümüze kadar geçen sürede kalitesini, teknolojik tezgah parkuru, vizyon sahibi yöneticileri ve çalışanlarıyla bütünleştirerek sektörde hak ettiği değeri görmüştür.

Kaliteden ödün vermeyen üretim anlayışı, rekabetçi fiyat politikası ve zengin ürün çeşidi ile başta ülkemiz olmak üzere, dünyada da kalıplılık sektörüne katkıda bulunmaktadır.

UKS Kalıp Elemanları iç pazardaki satış başarısını adım adım daha ileriye taşımaktadır. Başta Avrupa ülkeleri olmak üzere dünyanın değişik ülkelerine ihracat yaparak ülke ekonomisine katkıda bulunmaktadır.

UKS Kalıp Elemanları, standart kalıp elemanları pazarında "en iyi" olmak yolunda hızla ilerlemektedir.

*UKS Mold Components has almost half a century of experience in Mould Making Industry and since 2004 has added mould components to its expertise. This experience assures consistent production quality and achieves total customer satisfaction by providing high quality and tailored products that will completely meet customer specifications.*

*UKS mould components is not only reliable but also its efficient production process enables response even to short notices with competitive pricing and on-time delivery.*

*UKS Mold Components believes that production of moulds and mould components needs professional understating of management, experienced and dynamic team and machinery of latest technology. Continuous growth has helped the company to achieve to be one of the leading suppliers of high quality, standard and non-standard moulds and mould components.*

*UKS Mold Components' stock contains wide variety of standard components to serve it's customers.*

*UKS Mold Components has certified with ISO-9001:2000 Quality Management System in 2004. The companie's sales success in domestic area advanced further and now exporting to 7 different countries and 3 different continents.*



**K**  
**UKS**  
KALIP ELEMANLARI  
MOLD COMPONENTS



[www.uks.com.tr](http://www.uks.com.tr)

# İÇİNDEKİLER / INDEX

## ENJEKSİYON KALIP ÜRÜNLERİ Injection Mould Components



### U01

Şapkalı Kolon  
Guide Pillar

S.06 - 08



### U01H

Şapkalı Kolon  
Guide Pillar

S.09 - 11



### U02

Şapkalı Kademeli Kolon  
Guide Pillar

S.12 - 27



### U03H

Kuy. Şapkalı  
Kad. Kolon  
Tailed Guide Pillar

S.28 - 41



### U06

Açılı Şapkalı Kolon  
Angle Guide Pillar

S.42 - 44



### U07

Masuralı Bilyalı Burç  
Recirculating Ball Bearing

S.45

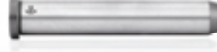

### U08

Kolon  
Guide Pillar

S.46



### U10

Yağ Kanalsız  
Şapkalı Kolon  
Guide Pillar

S.47 - 49



### U11

Alyan Başlı  
Yağ Kanalsız Kolon  
Guide Pillar

S.50 - 51



### U12

Merkezleme Burcu  
Centering Bush

S.52



### U13

Masuralı Şapkalı Burç  
Recirculating  
Guide Bush

S.53



### U20

Şapkalı Burç  
Guide Bush

S.54 - 56



### U21H

Kuyruklu Şapkalı Burç  
Tailed Guide Bush

S.57 - 59



### U22

Ortadan Flaşlı Burç  
Middle Flanged Bush

S.60



### U22B

Bilyalı Ortadan  
Flaşlı Burç  
Guide Bush with Ball Cage

S.61



### U40H

Tespit Burcu  
Centring Slaves

S.62 - 63



### U50

Konik Kitleme  
Locating Unit

S.64



### U100

Boynuz Pimi Yatağı  
Retainer

S.65

# İÇİNDEKİLER / INDEX

**SAC KALIP ÜRÜNLERİ**  
Punching Mould Components



**U00**

Ortadan Şapkalı Kolon  
Guide Pillar

**S.68 - 71**



**U09**

Düz Kolon  
Guide Pillar

**S.72 - 74**



**U23**

Ortadan Şapkalı Burç  
Guide Bush

**S.75**



**U24**

Üstten Şapkalı Burç  
Guide Bush

**S.76**



**U25**

Uzun Bronz Geçmeli Burç  
Guide Bush With Bronze

**S.77**



**U26**

Kısa Bronz Geçmeli Burç  
Guide Bush With Bronze

**S.78**



**U27**

Şapkalı Bilyalı Burç  
Guide Bush

**S.79**



**U28**

Kısa Bilyalı Burç  
Guide Bush

**S.80**



**U60**

Bilyalı Burç  
Ball Guide Bush

**S.81 - 82**



**U90**

Bağlama Pabucu  
Pillar & Bush Clamp

**S.83**

# ENJEKSİYON KALIP ÜRÜNLERİ

Injection Mould  
Components



# Enjeksiyon Kalıp Ürünleri Kombinasyon Şeması

## Injection Mould Components Combination Chart

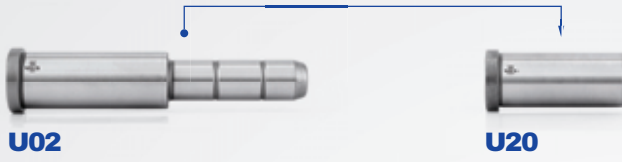
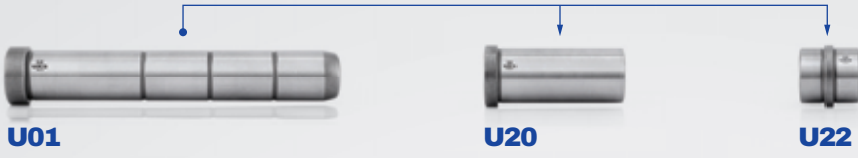

## U01

### Şapkalı Kolon

#### Guide Pillar

Malzeme / Material  
1.7131 (16MnCr5)

Sertlik / Hardness  
61 - 63 HRC

Isıl İşlem / Heat Treatment

Sementasyon / Case Hardened

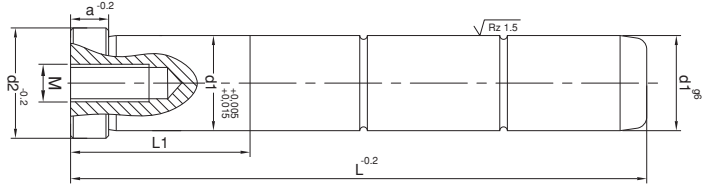
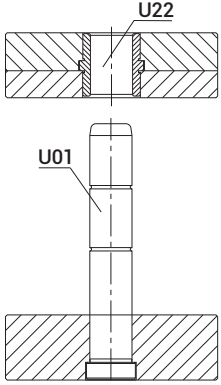

Sipariş Kodu / Order Code	d1	L	L1	d2	a	M
<b>U01-1260</b>	12	60	22	16	10	-
80		80				
100		100	27			
120		120				
140		140	36			
160		160				
<b>U01-1460</b>	14	60	22	18	10	-
80		80				
100		100	27			
120		120				
140		140	36			
160		160				
180	180	46				
<b>U01-1660</b>	16	60	22	20	10	6
80		80				
100		100	27			
120		120				
140		140	36			
160		160				
180		180	46			
200		200	56			
220		220				
250	250	66				



## U01

### Şapkalı Kolon

#### Guide Pillar

Malzeme / Material  
1.7131 (16MnCr5)

Sertlik / Hardness  
61 - 63 HRC

Isıl İşlem / Heat Treatment

Sementasyon / Case Hardened

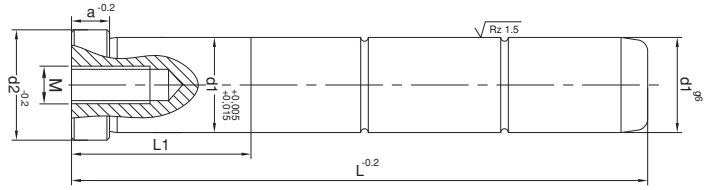
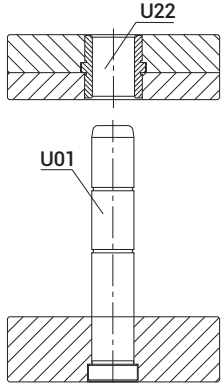

Sipariş Kodu / Order Code	d1	L	L1	d2	a	M
<b>U01-1860</b>	18	60	22	22	10	6
80		80	27			
100		100				
120		120				
140		140				
160		160				
180		180				
200		200				
220		20				
80	80		27			
100	100					
120	120					
140	140					
160	160					
180	180					
200	200					
220	220					
250	250					
280	280			66		
300	300	76				
315	315					

## U01

### Şapkalı Kolon

#### Guide Pillar

Malzeme / Material  
1.7131 (16MnCr5)

Sertlik / Hardness  
61 - 63 HRC

Isıl İşlem / Heat Treatment

Sementasyon / Case Hardened

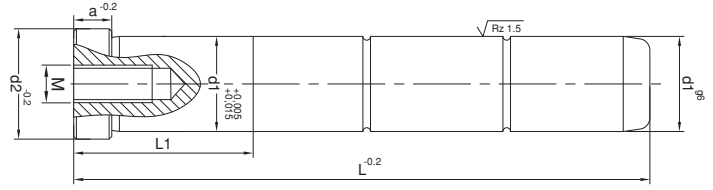
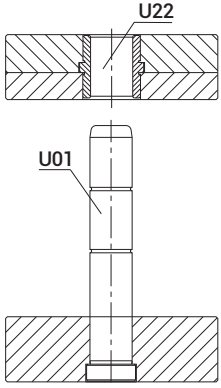

Sipariş Kodu / Order Code	d1	L	L1	d2	a	M
U01-25100	25	100	27	29	10	8
120		120	36			
140		140				
160		160				
180		180	46			
200		200	56			
220		220				
250		250	66			
300		300	76			
U01-30100		30	100			
120	120		36			
140	140					
160	160					
180	180		46			
200	200		56			
220	220					
250	250		66			
300	300		76			
U01-40160	40		160	36	48	15
180		180	46			
200		200	56			
220		220				
250		250	66			
280		280				
300		300	76			
315		320				
360		360				

## U01H

### Şapkalı Kolon

#### Guide Pillar

Malzeme / Material  
1.7131 (16MnCr5)

Sertlik / Hardness  
61 - 63 HRC

Isıl İşlem / Heat Treatment

Sementasyon / Case Hardened

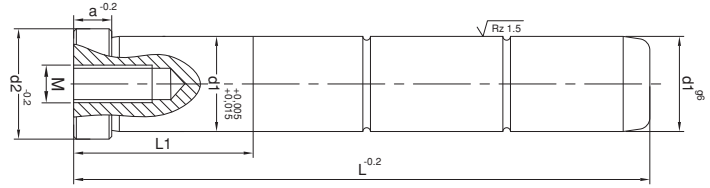
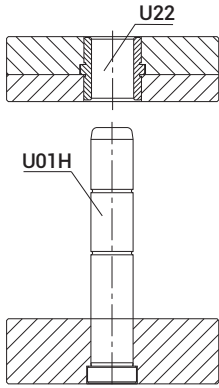

Sipariş Kodu / Order Code	d1	L	L1	d2	a	M
<b>U01H-1260</b>	12	60	22	16	6	-
80		80				
100		100	27			
120		120	36			
140		140				
160		160				
<b>U01H-1460</b>	14	60	22	18	8	-
80		80				
100		100	27			
120		120	36			
140		140				
160		160				
<b>U01H-1660</b>	16	60	22	20	8	6
80		80				
100		100	36			
120		120				
140		140				
160		160	46			
180	180					
200	200	56				

## U01H

### Şapkalı Kolon

#### Guide Pillar

**Malzeme / Material**  
1.7131 (16MnCr5)

**Sertlik / Hardness**  
61 - 63 HRC

**Isıl İşlem / Heat Treatment**

**Sementasyon / Case Hardened**

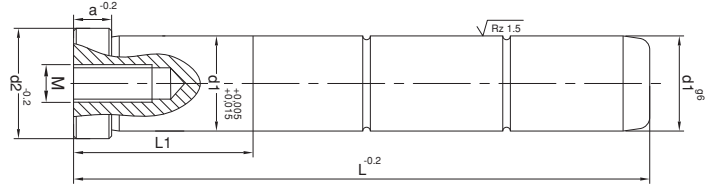
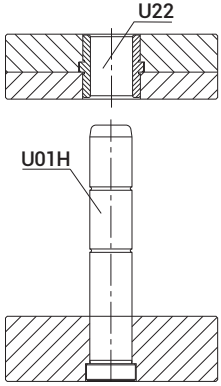

Sipariş Kodu / Order Code	d1	L	L1	d2	a	M
<b>U01H-1860</b>	18	60	22	22	8	6
80		80				
100		100	36			
120		120				
140		140				
160		160	46			
180		180				
200		200	56			
240		240				
<b>U01H-2060</b>		20	60			
80	80					
100	100		36			
120	120					
140	140					
160	160		46			
180	180					
200	200		56			
240	240		76			

# U01H

## Şapkalı Kolon

### Guide Pillar

Malzeme / Material  
1.7131 (16MnCr5)

Sertlik / Hardness  
61 - 63 HRC

Isıl İşlem / Heat Treatment  
Sementasyon / Case Hardened

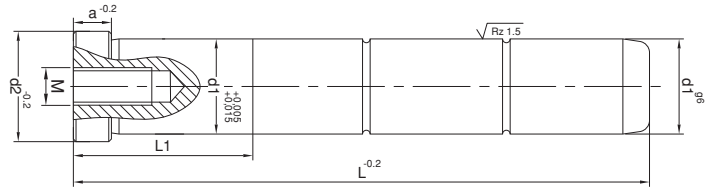
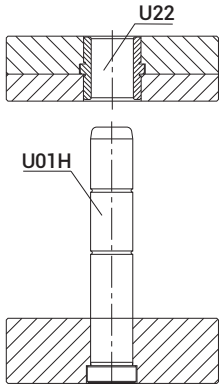

Sipariş Kodu / Order Code	d1	L	L1	d2	a	M
<b>U01H-2480</b>	24	80	22	28	15	8
100		100	36			
120		120				
140		140				
160		160	46			
180		180	56			
200		200				
220		220				
240		240	66			
300		300				
<b>U01H-30100</b>	30	100	36	36	15	8
120		120				
140		140				
160		160	46			
180		180	56			
200		200	66			
220		220				
240		240				
300		300	76			
360		360				

## U02

### Şapkalı Kademeli Kolon Guide Pillar

Malzeme / Material  
1.7131 (16MnCr5)  
Sertlik / Hardness  
61 - 63 HRC  
Isıl İşlem / Heat Treatment  
Sementasyon / Case Hardened

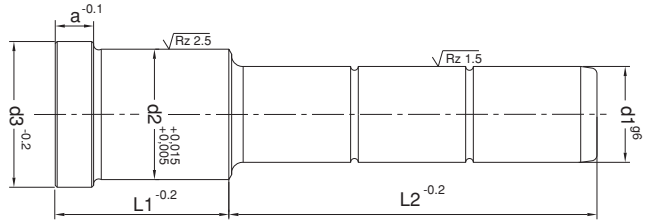
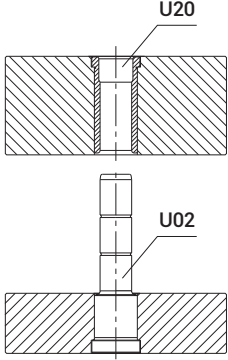

Sipariş Kodu / Order Code	d1	L1	L2	d2	d3	a
<b>U02-122626</b>			26			
36	12	26	36	16	19	4
46			46			
56			56			
<b>U02-123626</b>			26			
36	12	36	36	16	19	4
46			46			
56			56			
<b>U02-124626</b>			26			
36	12	46	36	16	19	4
46			46			
56			56			
66			66			
<b>U02-142626</b>			26			
36	14	26	36	20	25	6
46			46			
56			56			
66			66			
76			76			
<b>U02-143626</b>			26			
36	14	36	36	20	25	6
46			46			
56			56			
66			66			
86			86			

## U02

### Şapkalı Kademeli Kolon Guide Pillar

Malzeme / Material  
1.7131 (16MnCr5)  
Sertlik / Hardness  
61 - 63 HRC  
Isıl İşlem / Heat Treatment  
Sementasyon / Case Hardened

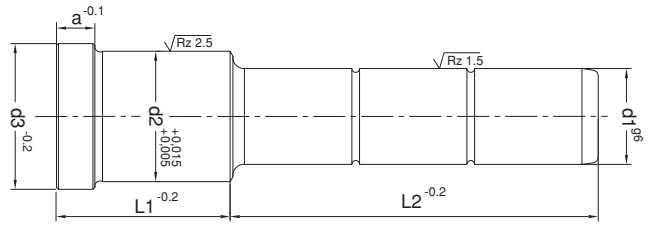
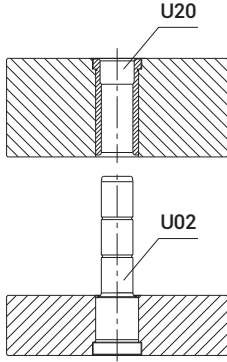

Sipariş Kodu / Order Code	d1	L1	L2	d2	d3	a
<b>U02-144626</b>	14	46	26	20	25	6
36			36			
46			46			
56			56			
76			76			
96			96			
<b>U02-145626</b>	14	56	26	20	25	6
36			36			
46			46			
66			66			
86			86			
106			106			
<b>U02-162626</b>	16	26	26	24	28	6
36			36			
46			46			
56			56			
76			76			
96			96			
<b>U02-163626</b>	16	36	26	24	28	6
36			36			
46			46			
56			56			
66			66			
86			86			
106	106					

## U02

### Şapkalı Kademeli Kolon Guide Pillar

Malzeme / Material  
1.7131 (16MnCr5)

Sertlik / Hardness  
61 - 63 HRC

Isıl İşlem / Heat Treatment

Sementasyon / Case Hardened

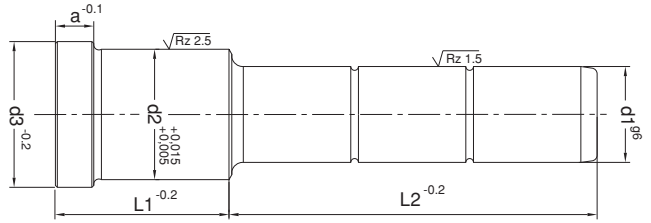
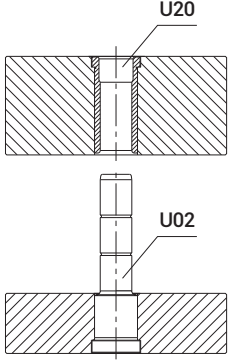

Sipariş Kodu / Order Code	d1	L1	L2	d2	d3	a
<b>U02-164626</b>	16	46	26	24	28	6
36			36			
46			46			
56			56			
66			66			
76			76			
96			96			
116			116			
<b>U02-165626</b>	16	56	26	24	28	6
36			36			
46			46			
56			56			
66			66			
76			76			
96			96			
116			116			
<b>U02-166626</b>	16	66	26	24	28	6
36			36			
46			46			
56			56			
66			66			
76			76			
86			86			
106			106			
116	116					



## U02

### Şapkalı Kademeli Kolon Guide Pillar

Malzeme / Material  
1.7131 (16MnCr5)  
Sertlik / Hardness  
61 - 63 HRC  
Isıl İşlem / Heat Treatment  
Sementasyon / Case Hardened

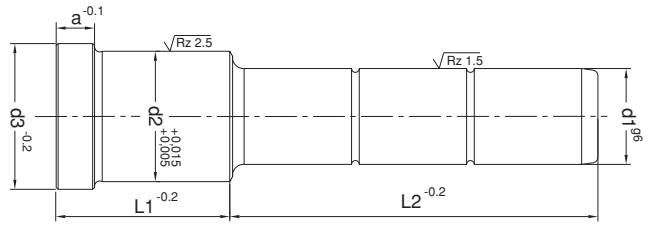
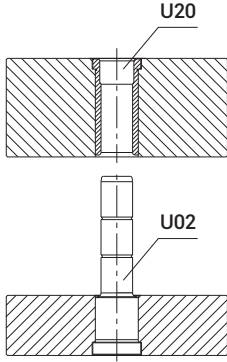

Sipariş Kodu / Order Code	d1	L1	L2	d2	d3	a
<b>U02-167626</b>	16	76	26	24	28	6
36			36			
46			46			
56			56			
66			66			
76			76			
96			96			
116			116			
<b>U02-168626</b>	16	86	26	24	28	6
36			36			
46			46			
56			56			
66			66			
76			76			
96			96			
116			116			
<b>U02-182626</b>	18	26	26	26	31	6
36			36			
46			46			
56			56			
66			66			
86			86			

## U02

### Şapkalı Kademeli Kolon Guide Pillar

Malzeme / Material  
1.7131 (16MnCr5)  
Sertlik / Hardness  
61 - 63 HRC  
Isıl İşlem / Heat Treatment  
Sementasyon / Case Hardened

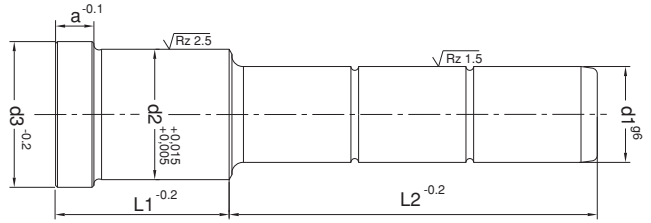
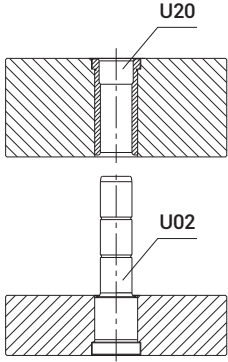

Sipariş Kodu / Order Code	d1	L1	L2	d2	d3	a
<b>U02-183626</b>	18	36	26	26	31	6
36			36			
46			46			
56			56			
66			66			
86			86			
106			106			
<b>U02-184626</b>	18	46	26	26	31	6
36			36			
46			46			
56			56			
66			66			
86			86			
106			106			
126	126					
<b>U02-185626</b>	18	56	26	26	31	6
36			36			
46			46			
56			56			
66			66			
86			86			
106			106			
126	126					

## U02

### Şapkalı Kademeli Kolon Guide Pillar

Malzeme / Material  
1.7131 (16MnCr5)  
Sertlik / Hardness  
61 - 63 HRC  
Isıl İşlem / Heat Treatment  
Sementasyon / Case Hardened

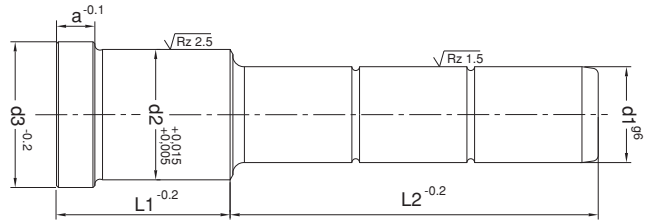
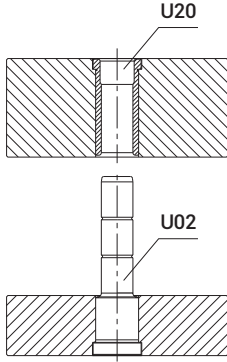

Sipariş Kodu / Order Code	d1	L1	L2	d2	d3	a
<b>U02-186626</b>	18	66	26	26	31	6
36			36			
56			56			
76			76			
96			96			
116			116			
<b>U02-187626</b>	18	76	26	26	31	6
46			46			
66			66			
86			86			
106			106			
126			126			
<b>U02-188626</b>	18	86	26	26	31	6
46			46			
66			66			
86			86			
106			106			
126			126			
<b>U02-202626</b>	20	26	26	28	32	6
36			36			
46			46			
56			56			
66			66			
86			86			

## U02

### Şapkalı Kademeli Kolon Guide Pillar

Malzeme / Material  
1.7131 (16MnCr5)

Sertlik / Hardness  
61 - 63 HRC

Isıl İşlem / Heat Treatment

Sementasyon / Case Hardened

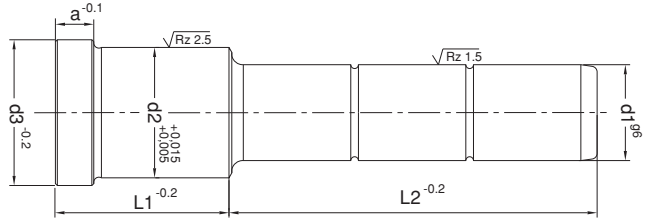
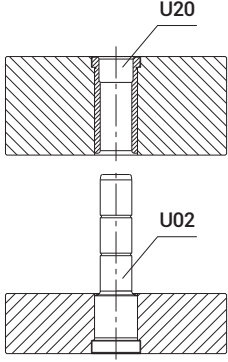

Sipariş Kodu / Order Code	d1	L1	L2	d2	d3	a
<b>U02-203626</b>	20	36	26	28	32	6
36			36			
46			46			
56			56			
66			66			
76			76			
96			96			
<b>U02-204626</b>	20	46	26	28	32	6
36			36			
46			46			
56			56			
66			66			
76			76			
86			86			
106	106					
<b>U02-205626</b>	20	56	26	28	32	6
36			36			
46			46			
56			56			
66			66			
76			76			
96			96			
116	116					

## U02

### Şapkalı Kademeli Kolon Guide Pillar

Malzeme / Material  
1.7131 (16MnCr5)  
Sertlik / Hardness  
61 - 63 HRC  
Isıl İşlem / Heat Treatment  
Sementasyon / Case Hardened

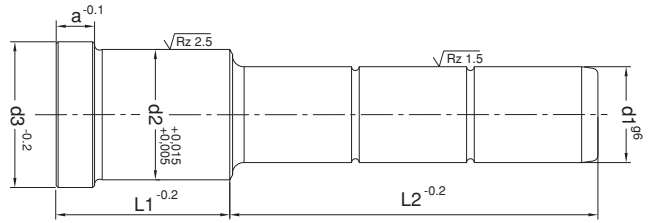
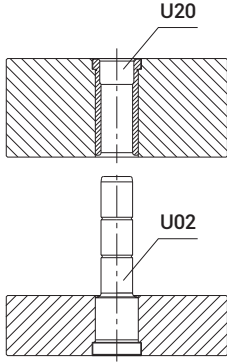

Sipariş Kodu / Order Code	d1	L1	L2	d2	d3	a
<b>U02-206626</b>	20	66	26	28	32	6
36			36			
46			46			
56			56			
66			66			
76			76			
96			96			
116			116			
<b>U02-207626</b>			20			
36	36					
46	46					
56	56					
66	66					
76	76					
86	86					
106	106					
126	126					
<b>U02-208626</b>	20	86	26	28	32	6
36			36			
46			46			
56			56			
66			66			
76			76			
86			86			
106			106			
126			126			

## U02

### Şapkalı Kademeli Kolon Guide Pillar

**Malzeme / Material**  
1.7131 (16MnCr5)  
**Sertlik / Hardness**  
61 - 63 HRC  
**Isıl İşlem / Heat Treatment**  
**Sementasyon / Case Hardened**

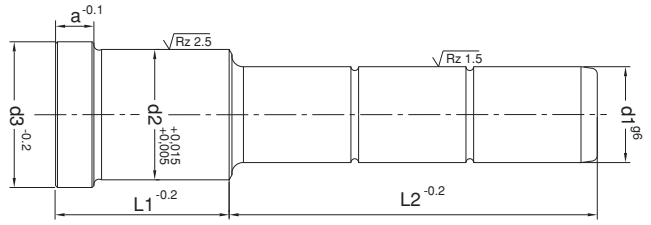
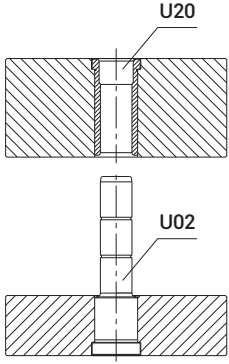

Sipariş Kodu / Order Code	d1	L1	L2	d2	d3	a
<b>U02-209626</b>	20	96	26	28	32	6
36			36			
46			46			
56			56			
66			66			
76			76			
86			86			
106			106			
126			126			
<b>U02-252626</b>	25	26	26	34	38	8
36			36			
46			46			
56			56			
66			66			
76			76			
96	96					
<b>U02-253626</b>	25	36	26	34	38	8
36			36			
46			46			
56			56			
66			66			
76			76			
86			86			
106	106					

## U02

### Şapkalı Kademeli Kolon Guide Pillar

Malzeme / Material  
1.7131 (16MnCr5)  
Sertlik / Hardness  
61 - 63 HRC  
Isıl İşlem / Heat Treatment  
Sementasyon / Case Hardened

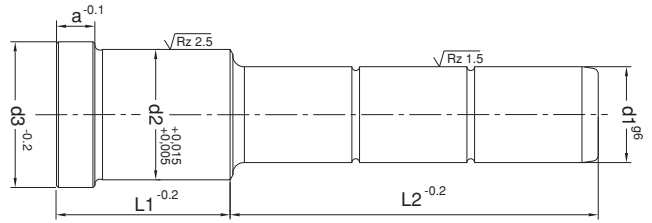
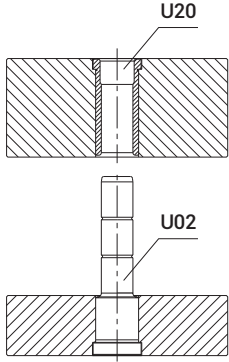

Sipariş Kodu / Order Code	d1	L1	L2	d2	d3	a
<b>U02-254626</b>	25	46	26	34	38	8
36			36			
46			46			
56			56			
66			66			
76			76			
96			96			
116			116			
<b>U02-255626</b>	25	56	26	34	38	8
36			36			
46			46			
56			56			
66			66			
76			76			
96			96			
116			116			
<b>U02-256626</b>	25	66	26	34	38	8
36			36			
46			46			
56			56			
66			66			
76			76			
86			86			
106			106			
126	126					

## U02

### Şapkalı Kademeli Kolon Guide Pillar

Malzeme / Material  
1.7131 (16MnCr5)

Sertlik / Hardness  
61 - 63 HRC

Isıl İşlem / Heat Treatment

Sementasyon / Case Hardened

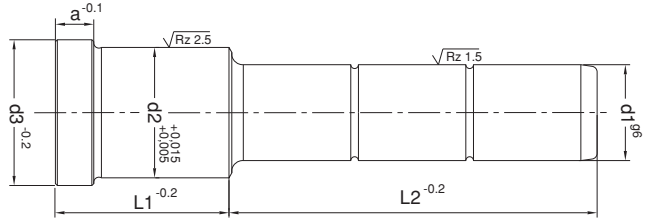
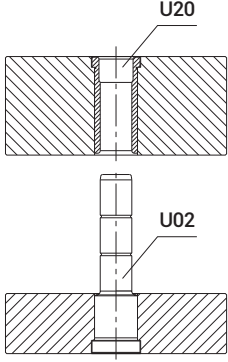

Sipariş Kodu / Order Code	d1	L1	L2	d2	d3	a
<b>U02-257626</b>	25	76	26	34	38	8
36						
46						
56						
66						
76						
86						
106						
126						
<b>U02-258636</b>	25	86	36	34	38	8
46						
56						
66						
76						
86						
96						
116						
136						
<b>U02-259636</b>	25	96	36	34	38	8
46						
56						
66						
76						
86						
96						
116						
136						



## U02

### Şapkalı Kademeli Kolon Guide Pillar

Malzeme / Material  
1.7131 (16MnCr5)  
Sertlik / Hardness  
61 - 63 HRC  
Isıl İşlem / Heat Treatment  
Sementasyon / Case Hardened

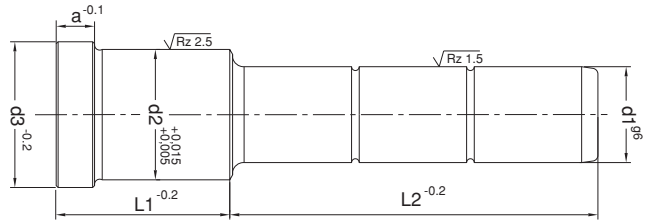
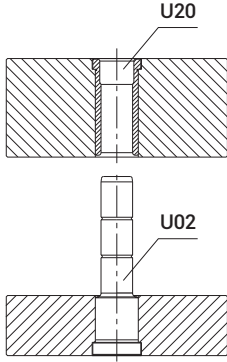

Sipariş Kodu / Order Code	d1	L1	L2	d2	d3	a
<b>U02-2510646</b>	25	106	46	34	38	8
56			56			
66			66			
76			76			
86			86			
96			96			
116			116			
136			136			
<b>U02-303636</b>	30	36	36	39	43	10
46			46			
56			56			
66			66			
86			86			
106			106			
<b>U02-304636</b>	30	46	36	39	43	10
46			46			
56			56			
66			66			
76			76			
96			96			
116	116					

## U02

### Şapkalı Kademeli Kolon Guide Pillar

Malzeme / Material  
1.7131 (16MnCr5)  
Sertlik / Hardness  
61 - 63 HRC  
Isıl İşlem / Heat Treatment  
Sementasyon / Case Hardened

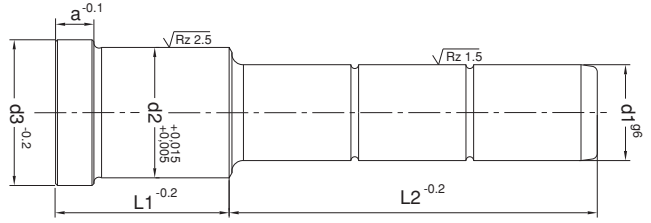
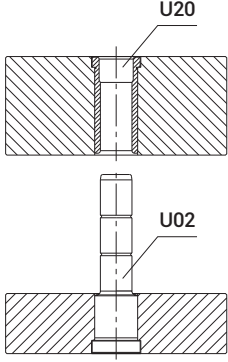

Sipariş Kodu / Order Code	d1	L1	L2	d2	d3	a
<b>U02-305636</b>	30	56	36	39	43	10
46			46			
56			56			
66			66			
76			76			
86			86			
106			106			
126			126			
<b>U02-306636</b>			30			
46	46					
56	56					
66	66					
76	76					
86	86					
96	96					
116	116					
136	136					
<b>U02-307636</b>	30	76	36	39	43	10
46			46			
56			56			
76			76			
96			96			
116			116			
136	136					

## U02

### Şapkalı Kademeli Kolon Guide Pillar

**Malzeme / Material**  
1.7131 (16MnCr5)  
**Sertlik / Hardness**  
61 - 63 HRC  
**Isıl İşlem / Heat Treatment**  
**Sementasyon / Case Hardened**

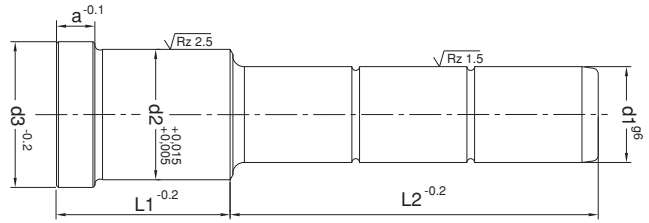
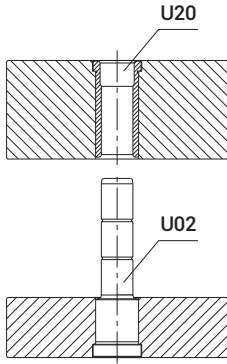

Sipariş Kodu / Order Code	d1	L1	L2	d2	d3	a
<b>U02-308636</b>	30	86	36	39	43	10
46			46			
66			66			
86			86			
106			106			
126			126			
146			146			
<b>U02-309646</b>	30	96	46	39	43	10
66			66			
86			86			
106			106			
146			146			
<b>U02-3010656</b>	30	106	56	39	43	10
76			76			
96			96			
116			116			
<b>U02-3011656</b>	30	116	56	39	43	10
76			76			
96			96			
136			136			

## U02

### Şapkalı Kademeli Kolon Guide Pillar

Malzeme / Material  
1.7131 (16MnCr5)

Sertlik / Hardness  
61 - 63 HRC

Isıl İşlem / Heat Treatment

Sementasyon / Case Hardened

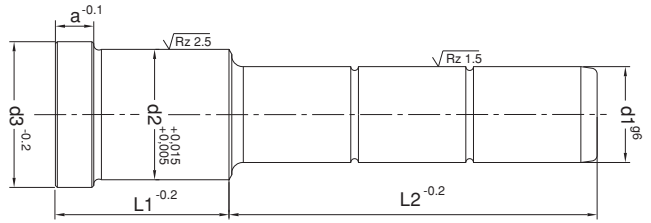
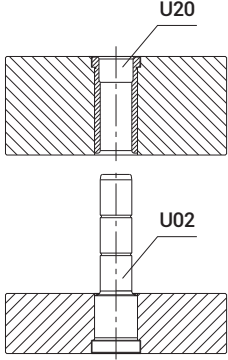

Sipariş Kodu / Order Code	d1	L1	L2	d2	d3	a
<b>U02-405656</b>	40	56	56	54	58	10
86						
106						
126						
156						
186						
<b>U02-406666</b>	40	66	66	54	58	10
96						
116						
136						
166						
196						
<b>U02-407676</b>	40	76	76	54	58	10
106						
126						
146						
166						
196						
216						
<b>U02-408686</b>	40	86	86	54	58	10
126						
146						
176						
206						
226						

## U02

### Şapkalı Kademeli Kolon Guide Pillar

Malzeme / Material  
1.7131 (16MnCr5)  
Sertlik / Hardness  
61 - 63 HRC  
Isıl İşlem / Heat Treatment  
Sementasyon / Case Hardened

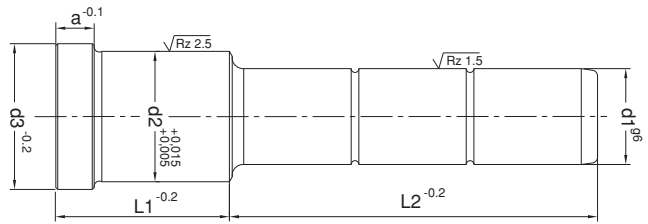
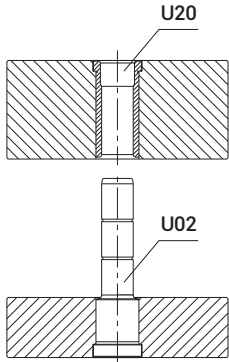

Sipariş Kodu / Order Code	d1	L1	L2	d2	d3	a
<b>U02-409696</b>	40	96	96	54	58	10
136			136			
156			156			
186			186			
216			216			
236			236			
<b>U02-40106106</b>	40	106	106	54	58	10
126			126			
156			156			
186			186			
226			226			
246			246			
<b>U02-40116116</b>	40	116	116	54	58	10
136			136			
166			166			
196			196			
236			236			
256			256			
<b>U02-40126126</b>	40	126	126	54	58	10
166			166			
196			196			
236			236			
266			266			
<b>U02-40136136</b>			40			
196	196					
226	226					
266	266					

## U03H

### Kuyruklu Şapkalı Kademeli Kolon Tailed Guide Pillar

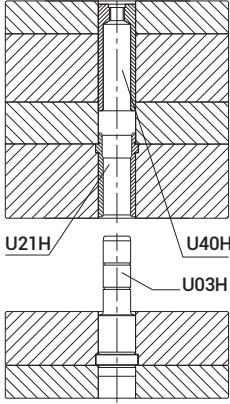

Malzeme / Material  
1.7131 (16MnCr5)

Sertlik / Hardness  
61 - 63 HRC

Isıl İşlem / Heat Treatment

Sementasyon / Case Hardened

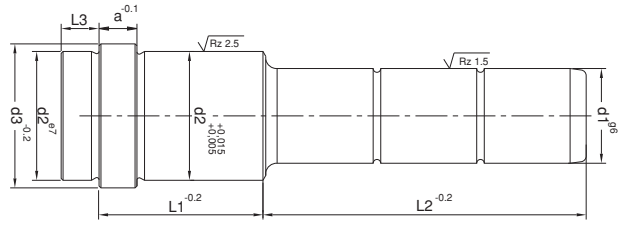

Sip. Kodu / Or. Code	d1	Sip. Kodu / Or. Code	d1	L1	L2	d2	d3	a	L3
<b>U03H-141735</b>	14	<b>U03H-151735</b>	15	17	35	20	25	6	9
55		55							
75		75							
95		95							
<b>U03H-142230</b>	14	<b>U03H-152230</b>	15	22	30	20	25	6	9
50		50							
70		70							
90		90							
110		110							
125		125							
<b>U03H-142730</b>	14	<b>U03H-152730</b>	15	27	30	20	25	6	9
45		45							
65		65							
85		85							
105		105							
125		125							
<b>U03H-143635</b>	14	<b>U03H-153635</b>	15	36	35	20	25	6	9
55		55							
75		75							
95		95							
115		115							
125		125							
<b>U03H-143635</b>	14	<b>U03H-153635</b>	15	36	35	20	25	6	9
55		55							
75		75							
95		95							
115		115							
125		125							
<b>U03H-143635</b>	14	<b>U03H-153635</b>	15	36	35	20	25	6	9
55		55							
75		75							
95		95							
115		115							
125		125							

## U03H

### Kuyruklu Şapkalı Kademeli Kolon Tailed Guide Pillar

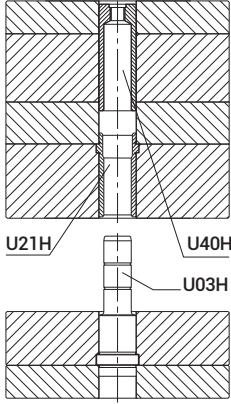

Malzeme / Material  
1.7131 (16MnCr5)

Sertlik / Hardness  
61 - 63 HRC

Isıl İşlem / Heat Treatment

Sementasyon / Case Hardened



U21H



U40H

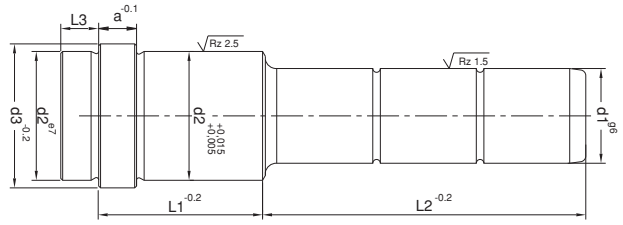

Sip. Kodu / Or. Code	d1	Sip. Kodu / Or. Code	d1	L1	L2	d2	d3	a	L3
U03H-144635	14	U03H-154635	15	46	35	20	25	6	9
45		45							
65		65							
85		85							
105		105							
125		125							
145		145							
U03H-145635	14	U03H-155635	15	56	35	20	25	6	9
55		55							
75		75							
95		95							
135		135							
U03H-146655	14	U03H-156655	15	66	55	20	25	6	9
65		65							
85		85							
95		95							
105		105							
125	125								
U03H-147635	14	U03H-157635	15	76	35	20	25	6	9
55		55							
75		75							
95		95							
125		125							

## U03H

### Kuyruklu Şapkalı Kademeli Kolon Tailed Guide Pillar

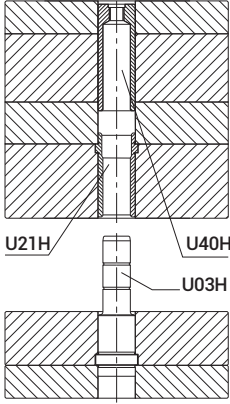

Malzeme / Material  
1.7131 (16MnCr5)

Sertlik / Hardness  
61 - 63 HRC

Isıl İşlem / Heat Treatment

Sementasyon / Case Hardened

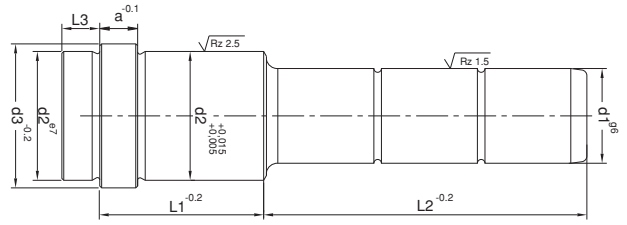

Sip. Kodu / Or. Code	d1	Sip. Kodu / Or. Code	d1	L1	L2	d2	d3	a	L3
U03H-148655	14	U03H-158655	15	86	55	20	25	6	9
75		75			75				
95		95			95				
U03H-149655	14	U03H-159655	15	96	55	20	25	6	9
75		75			75				
95		95			95				
U03H-1411675	14	U03H-1511675	15	116	75	20	25	6	9
U03H-181735	18	U03H-201735	20	17	35	26	31	6	9
55		55			55				
75		75			75				
120		120			120				
U03H-182235	18	U03H-202235	20	22	35	26	31	6	9
45		45			45				
65		65			65				
85		85			85				
95		95			95				
115	115	115							
U03H-182735	18	U03H-202735	20	27	35	26	31	6	9
45		45			45				
65		65			65				
85		85			85				
105		105			105				
125		125			125				
165		165			165				
225	225	225							
245	245	245							



## U03H

### Kuyruklu Şapkalı Kademeli Kolon Tailed Guide Pillar

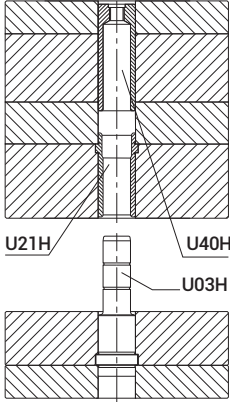

Malzeme / Material  
1.7131 (16MnCr5)

Sertlik / Hardness  
61 - 63 HRC

Isıl İşlem / Heat Treatment

Sementasyon / Case Hardened



U21H



U40H

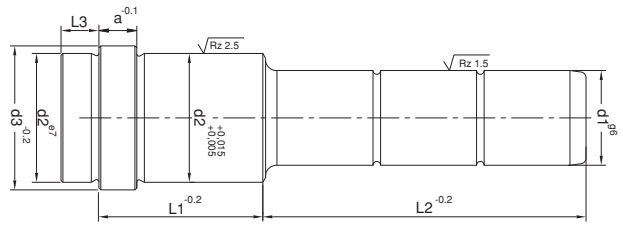

Sip. Kodu / Or. Code	d1	Sip. Kodu / Or. Code	d1	L1	L2	d2	d3	a	L3
U03H-183635	18	U03H-203635	20	36	35	26	31	6	9
55		55							
75		75							
95		95							
115		115							
135		135							
165		165							
225		225							
255	255								
U03H-184635	18	U03H-204635	20	46	35	26	31	6	9
45		45							
65		65							
85		85							
105		105							
135		135							
165	165								
245	245								
U03H-185635	18	U03H-205635	20	56	35	26	31	6	9
55		55							
75		75							
95		95							
115		115							
135		135							
155	155								

## U03H

### Kuyruklu Şapkalı Kademeli Kolon Tailed Guide Pillar

Malzeme / Material  
1.7131 (16MnCr5)

Sertlik / Hardness  
61 - 63 HRC

Isıl İşlem / Heat Treatment

Sementasyon / Case Hardened



**U21H**



**U40H**

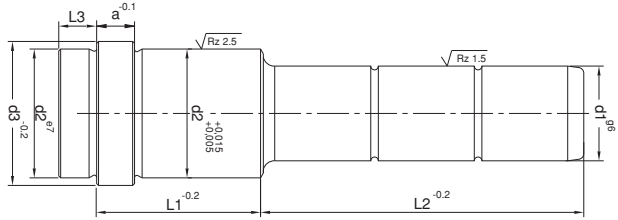
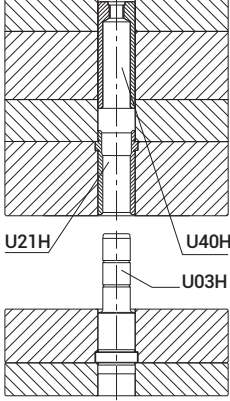

Sip. Kodu / Or. Code	d1	Sip. Kodu / Or. Code	d1	L1	L2	d2	d3	a	L3
<b>U03H-186635</b>	18	<b>U03H-206635</b>	20	66	35	26	31	6	9
55		55							
75		75							
95		95							
115		115							
135		135							
<b>U03H-187635</b>	18	<b>U03H-207635</b>	20	76	35	26	31	6	9
55		55							
75		75							
95		95							
135		135							
<b>U03H-188655</b>	18	<b>U03H-208655</b>	20	86	55	26	31	6	9
75		75							
95		95							
135		135							
<b>U03H-189655</b>	18	<b>U03H-209655</b>	20	96	55	26	31	6	9
75		75							
95		95							
<b>U03H-1811675</b>	18	<b>U03H-2011675</b>	20	116	75	26	31	6	9
115		115							
<b>U03H-18136135</b>	18	<b>U03H-20136135</b>	20	136	35	26	31	6	9

## U03H

### Kuyruklu Şapkalı Kademeli Kolon Tailed Guide Pillar

Malzeme / Material  
1.7131 (16MnCr5)

Sertlik / Hardness  
61 - 63 HRC

Isıl İşlem / Heat Treatment

Sementasyon / Case Hardened



U21H



U40H

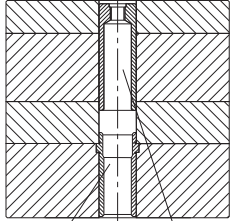

U21H U40H

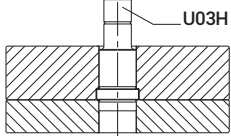

U03H

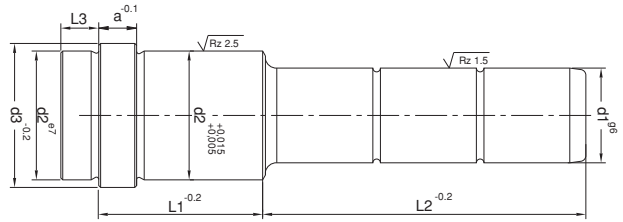

Sip. Kodu / Or. Code	d1	Sip. Kodu / Or. Code	d1	L1	L2	d2	d3	a	L3
U03H-221735	22	U03H-241735	24	17	35	30	35	6	9
55		55			55				
75		75			75				
U03H-222235	22	U03H-242235	24	22	35	30	35	6	9
55		55			55				
75		75			75				
95		95			95				
105		105			105				
130	130	130							
U03H-222735	22	U03H-242735	24	27	35	30	35	6	9
45		45			45				
65		65			65				
85		85			85				
105		105			105				
125		125			125				
165		165			165				
205		205			205				
245	245	245							

## U03H

### Kuyruklu Şapkalı Kademeli Kolon Tailed Guide Pillar

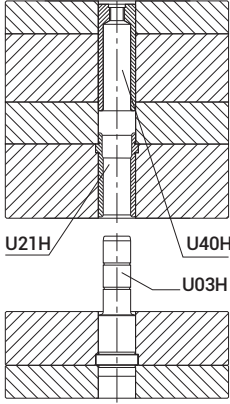

Malzeme / Material  
1.7131 (16MnCr5)

Sertlik / Hardness  
61 - 63 HRC

Isıl İşlem / Heat Treatment

Sementasyon / Case Hardened

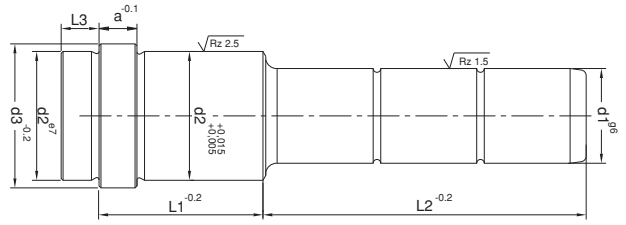

Sip. Kodu / Or. Code	d1	Sip. Kodu / Or. Code	d1	L1	L2	d2	d3	a	L3
<b>U03H-223635</b>	22	<b>U03H-243635</b>	24	36	35	30	35	6	9
55		55							
75		75							
95		95							
115		115							
135		135							
165		165							
205		205							
245		245							
285		285							
<b>U03H-224635</b>	22	<b>U03H-244635</b>	24	46	35	30	35	6	9
45		45							
65		65							
85		85							
105		105							
125		125							
165		165							
205		205							
<b>U03H-225635</b>	22	<b>U03H-245635</b>	24	56	35	30	35	6	9
55		55							
75		75							
95		95							
115		115							
135		135							

## U03H

### Kuyruklu Şapkalı Kademeli Kolon Tailed Guide Pillar

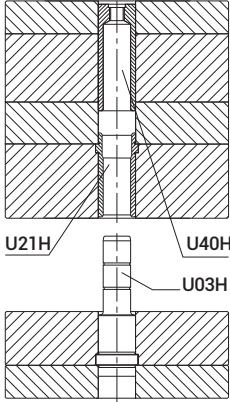

Malzeme / Material  
1.7131 (16MnCr5)

Sertlik / Hardness  
61 - 63 HRC

Isıl İşlem / Heat Treatment

Sementasyon / Case Hardened

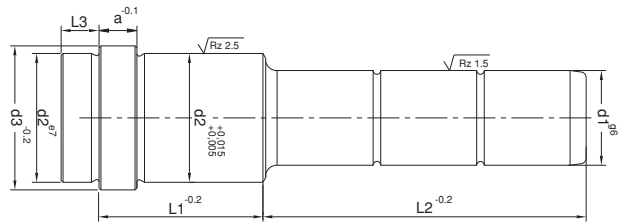

Sip. Kodu / Or. Code	d1	Sip. Kodu / Or. Code	d1	L1	L2	d2	d3	a	L3
U03H-2256165	22	U03H-2456165	24	56	165	30	35	6	9
205		205			205				
U03H-226635	22	U03H-246635	24	66	35	30	35	6	9
55		55			55				
75		75			75				
95		95			95				
115		115			115				
135		135			135				
155	155	155							
U03H-227635	22	U03H-247635	24	76	35	30	35	6	9
55		55			55				
75		75			75				
95		95			95				
115		115			115				
145	145	145							
U03H-228655	22	U03H-248655	24	86	55	30	35	6	9
75		75			75				
95		95			95				
125		125			125				
135	135	135							
U03H-229655	22	U03H-249655	24	96	55	30	35	6	9
75		75			75				
95		95			95				
125		125			125				

## U03H

### Kuyruklu Şapkalı Kademeli Kolon Tailed Guide Pillar

Malzeme / Material  
1.7131 (16MnCr5)

Sertlik / Hardness  
61 - 63 HRC

Isıl İşlem / Heat Treatment

Sementasyon / Case Hardened



**U21H**



**U40H**

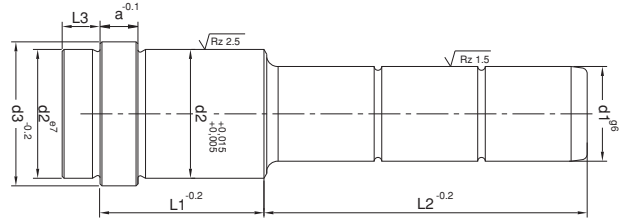
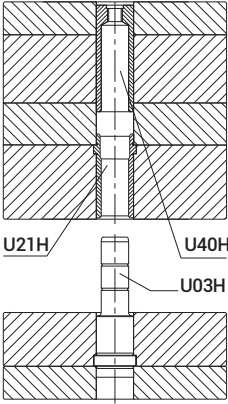

Sip. Kodu / Or. Code	d1	Sip. Kodu / Or. Code	d1	L1	L2	d2	d3	a	L3
<b>U03H-2210655</b>	22	<b>U03H-2410655</b>	24	106	55	30	35	6	9
75		75							
95		95							
115		115							
<b>U03H-2211675</b>	22	<b>U03H-2411675</b>	24	116	75	30	35	6	9
115		115							
155		155							
<b>U03H-2213695</b>	22	<b>U03H-2413695</b>	24	136	95	30	35	6	9
135		135							
<b>U03H-302735</b>	30	<b>U03H-322735</b>	32	27	35	42	47	6	9
45		45							
65		65							
85		85							
105		105							
125		125							
145		145							
165		165							
185		185							
245		245							
285	285								

## U03H

### Kuyruklu Şapkalı Kademeli Kolon Tailed Guide Pillar

Malzeme / Material  
1.7131 (16MnCr5)

Sertlik / Hardness  
61 - 63 HRC

Isıl İşlem / Heat Treatment

Sementasyon / Case Hardened



**U21H**



**U40H**

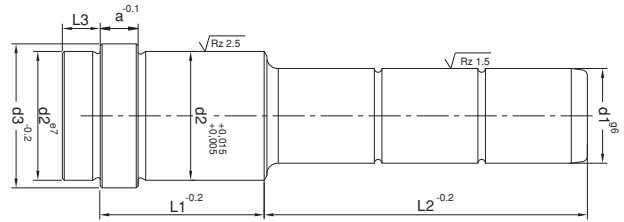
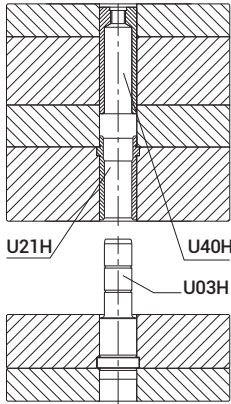

Sip. Kodu / Or. Code	d1	Sip. Kodu / Or. Code	d1	L1	L2	d2	d3	a	L3
<b>U03H-303635</b>	<b>30</b>	<b>U03H-323635</b>	<b>32</b>	<b>36</b>	<b>35</b>	<b>42</b>	<b>47</b>	<b>6</b>	<b>9</b>
<b>55</b>		<b>55</b>							
<b>75</b>		<b>75</b>							
<b>95</b>		<b>95</b>							
<b>115</b>		<b>115</b>							
<b>135</b>		<b>135</b>							
<b>155</b>		<b>155</b>							
<b>245</b>		<b>245</b>							
<b>285</b>		<b>285</b>							
<b>U03H-304645</b>	<b>30</b>	<b>U03H-324645</b>	<b>32</b>	<b>46</b>	<b>45</b>	<b>42</b>	<b>47</b>	<b>6</b>	<b>9</b>
<b>65</b>		<b>65</b>							
<b>85</b>		<b>85</b>							
<b>105</b>		<b>105</b>							
<b>125</b>		<b>125</b>							
<b>145</b>		<b>145</b>							
<b>165</b>		<b>165</b>							
<b>245</b>		<b>245</b>							
<b>285</b>		<b>285</b>							

## U03H

### Kuyruklu Şapkalı Kademeli Kolon Tailed Guide Pillar

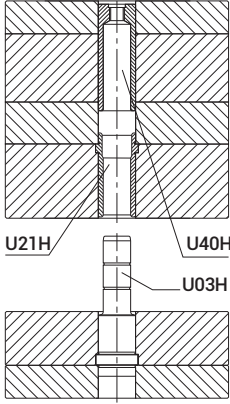

Malzeme / Material  
1.7131 (16MnCr5)

Sertlik / Hardness  
61 - 63 HRC

Isıl İşlem / Heat Treatment

Sementasyon / Case Hardened



U21H



U40H

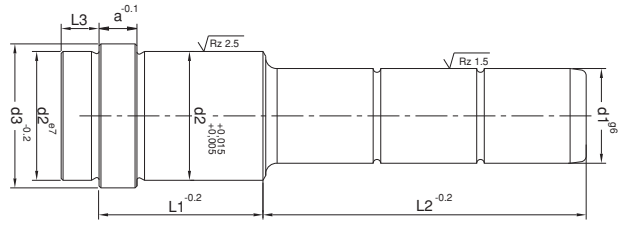

Sip. Kodu / Or. Code	d1	Sip. Kodu / Or. Code	d1	L1	L2	d2	d3	a	L3
U03H-305645	30	U03H-325645	32	56	45	42	47	6	9
55		55							
75		75							
95		95							
115		115							
135		135							
155		155							
175		175							
245		245							
295		295							
U03H-306645	30	U03H-326645	32	66	45	42	47	6	9
55		55							
75		75							
95		95							
115		115							
135		135							
155		155							
175		175							
245	245								
295	295								
U03H-307655	30	U03H-327655	32	76	55	42	47	6	9
75		75							
95		95							
115		115							
135		135							
155		155							
225	225								



## U03H

### Kuyruklu Şapkalı Kademeli Kolon Tailed Guide Pillar

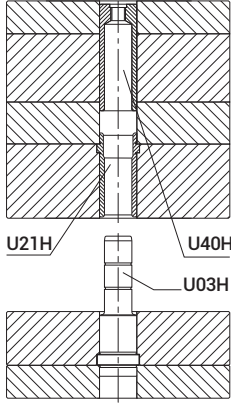

Malzeme / Material  
1.7131 (16MnCr5)

Sertlik / Hardness  
61 - 63 HRC

Isıl İşlem / Heat Treatment

Sementasyon / Case Hardened

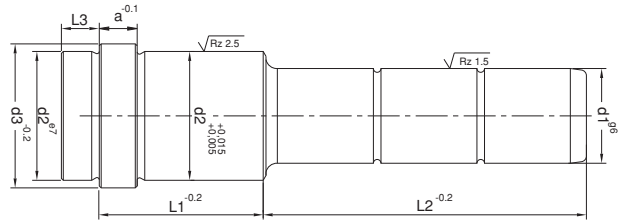

Sip. Kodu / Or. Code	d1	Sip. Kodu / Or. Code	d1	L1	L2	d2	d3	a	L3
U03H-308655	30	U03H-328655	32	86	55	42	47	6	9
75		75							
95		95							
115		115							
135		135							
155		155							
225	225								
U03H-309655	30	U03H-329655	32	96	55	42	47	6	9
75		75							
95		95							
115		115							
135		135							
155		155							
205	205								
U03H-3010675	30	U03H-3210675	32	106	75	42	47	6	9
95		95							
115		115							
125		125							
145		145							
165	165								
U03H-3011675	30	U03H-3211675	32	116	75	42	47	6	9
95		95							
115		115							
135		135							
155		155							

## U03H

### Kuyruklu Şapkalı Kademeli Kolon Tailed Guide Pillar

Malzeme / Material  
1.7131 (16MnCr5)

Sertlik / Hardness  
61 - 63 HRC

Isıl İşlem / Heat Treatment

Sementasyon / Case Hardened



U21H



U40H

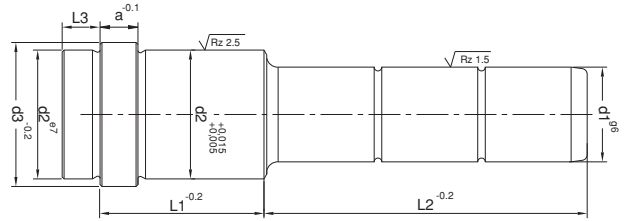
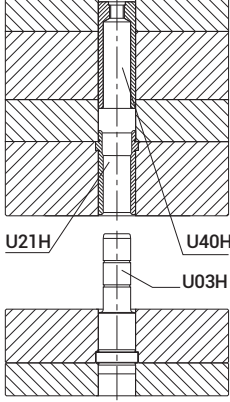

Sip. Kodu / Or. Code	d1	Sip. Kodu / Or. Code	d1	L1	L2	d2	d3	a	L3
U03H-3013695		U03H-3213695			95				
115	30	115	32	136	115	42	47	6	9
135		135			135				
155		155			155				
U03H-30156115	30	U03H-32156115	32	156	115	42	47	6	9
155		155			155				
U03H-30196155	30	U03H-32196155	32	196	155	42	47	6	9
195		195			195				
U03H-404695	40	U03H-424695	42	46	95	54	60	10	12
165		165			165				
U03H-405675		U03H-425675			75				
115	40	115	42	56	115	54	60	10	12
155		155			155				
195		195			195				
U03H-406675	40	U03H-426675	42	66	75	54	60	10	12
135		135			135				
U03H-407675		U03H-427675			75				
115	40	115	42	76	115	54	60	10	12
175		175			175				
U03H-408675	40	U03H-428675	42	86	75	54	60	10	12
135		135			135				
U03H-409675		U03H-429675			75				
115	40	115	42	96	115	54	60	10	12
155		155			155				

## U03H

### Kuyruklu Şapkalı Kademeli Kolon Tailed Guide Pillar

Malzeme / Material  
1.7131 (16MnCr5)  
Sertlik / Hardness  
61 - 63 HRC  
Isıl İşlem / Heat Treatment  
Sementasyon / Case Hardened



U21H



U40H

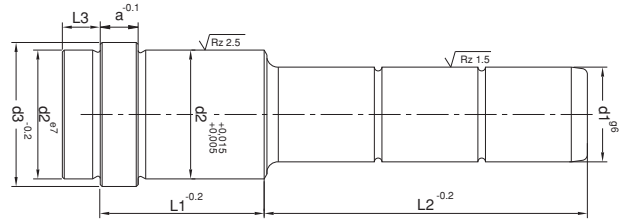
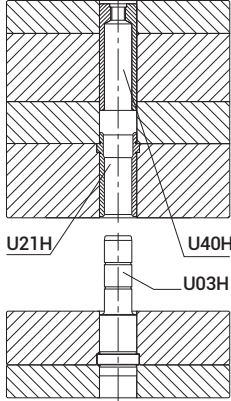

Sip. Kodu / Or. Code	d1	Sip. Kodu / Or. Code	d1	L1	L2	d2	d3	a	L3
U03H-4011695	40	U03H-4211695	42	116	95	54	60	10	12
135		135							
195		195							
U03H-4013695	40	U03H-4213695	42	136	95	54	60	10	12
135		135							
215		215							
U03H-40156115	40	U03H-42156115	42	156	115	54	60	10	12
155		155							
215		215							
U03H-40196155	40	U03H-42196155	42	196	155	54	60	10	12
195		195							
235		235							
U03H-40246165	40	U03H-42246165	42	246	165	54	60	10	12
245		245							

## U06

### Açılı Şapkalı Kolon Angled Guide Pillar

Malzeme / Material  
1.7131 (16MnCr5)

Sertlik / Hardness  
61 - 63 HRC

Isıl İşlem / Heat Treatment

Sementasyon / Case Hardened



**U100**

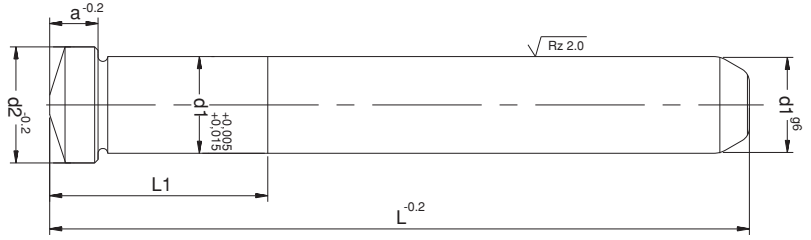

Sipariş Kodu / Order Code	d1	L	L1	d2	a
U06-1260	12	60	17	16	9
80		80	22		
100		100	27		
120		120			
140		140	36		
160		160			
180		180			
U06-1460	14	60	17	18	9
80		80	22		
100		100	27		
120		120			
140		140	36		
160		160			
180		180	46		
200	200				
U06-1660	16	60	17	20	10
80		80	22		
100		100	27		
120		120			
140		140	36		
160		160			
180		180	46		
200	200				
220	220	56			
240	240				

## U06

### Açılı Şapkalı Kolon Angled Guide Pillar

Malzeme / Material  
1.7131 (16MnCr5)

Sertlik / Hardness  
61 - 63 HRC

Isıl İşlem / Heat Treatment

Sementasyon / Case Hardened



**U100**

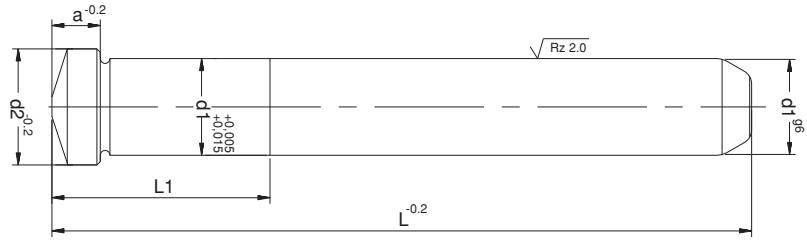

Sipariş Kodu / Order Code	d1	L	L1	d2	a
<b>U06-2080</b>	20	80	22	24	10
100		100	27		
120		120			
140		140	36		
160		160			
180		180	46		
200		200	56		
220		220			
240		240	66		
260		260			
280		280			
<b>U06-2580</b>		25	80		
100	100		27		
120	120				
140	140		36		
160	160				
180	180		46		
200	200		56		
220	220				
240	240		66		
260	260				
280	280		76		
300	300				

## U06

### Açılı Şapkalı Kolon Angled Guide Pillar

**Malzeme / Material**  
1.7131 (16MnCr5)

**Sertlik / Hardness**  
61 - 63 HRC

**Isıl İşlem / Heat Treatment**

**Sementasyon / Case Hardened**



**U100**

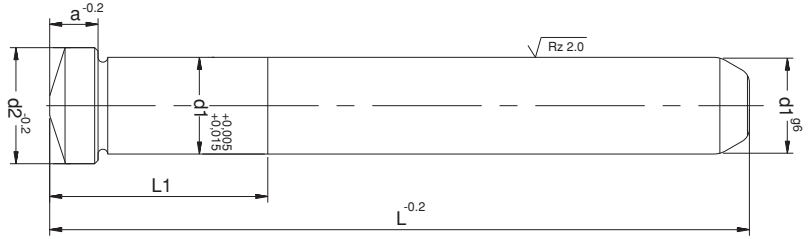

Sipariş Kodu / Order Code	d1	L	L1	d2	a
<b>U06-30100</b>	30	100	27	34	12
120		120			
140		140	36		
160		160			
180		180	46		
200		200	56		
220		220			
240		240	66		
280		280			
320		320	76		
360		360	86		

## U07

### Masuralı Bilyalı Burç Recirculating Ball Bearing

**Malzeme / Material**  
1.7131 (16MnCr5)

**Sertlik / Hardness**  
61 - 63 HRC

**Isıl İşlem / Heat Treatment**

**Sementasyon / Case Hardened**

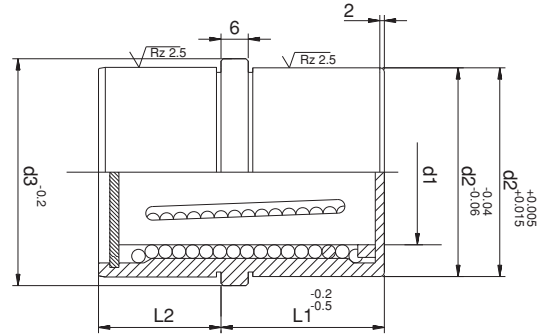
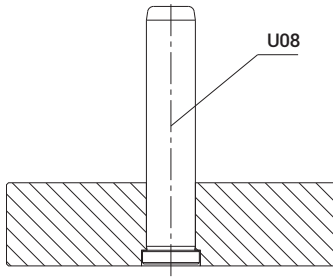
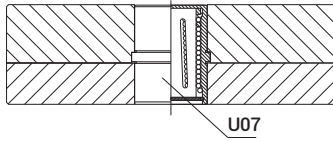

Sipariş Kodu / Order Code	d1	L1	L2	d2	d3
U07-121217	12	17	12	22	25
U07-181722	18	22	17	30	33
U07-242227	24	27	22	38	41
U07-302736	30	36	27	46	49

## U08

### Kolon

#### Guide Pillar

**Malzeme / Material**  
1.7131 (16MnCr5)

**Sertlik / Hardness**  
61 - 63 HRC

**Isıl İşlem / Heat Treatment**

**Sementasyon / Case Hardened**

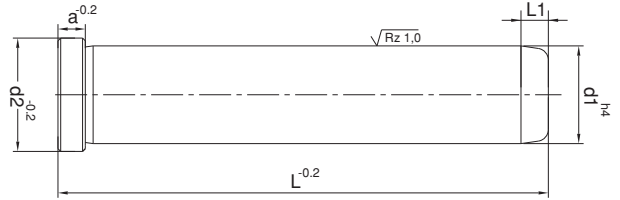
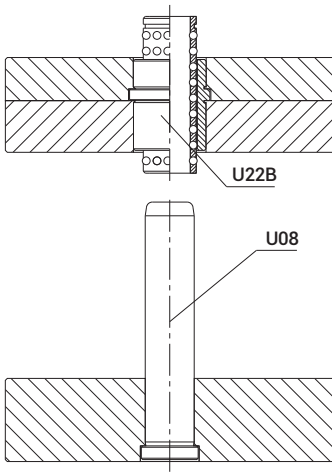

Sipariş Kodu / Order Code	d1	L	L1	d2	a
<b>U08-1280</b>		<b>80</b>			
100	12	100	4	16	4
120		120			
<b>U08-18120</b>		<b>120</b>			
140	18	140	7	22	6
160		160			
<b>U08-24140</b>		<b>140</b>			
180	24	180	7	28	6
220		220			
<b>U08-30160</b>		<b>160</b>			
200	30	200	7	36	6
240		240			



## U10

### Yağ Kanalsız Şapkalı Kolon Guide Pillar

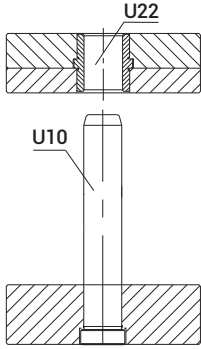

Malzeme / Material  
1.7131 (16MnCr5)

Sertlik / Hardness  
61 - 63 HRC

Isıl İşlem / Heat Treatment

Sementasyon / Case Hardened

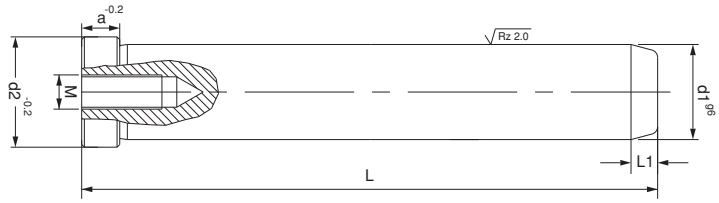

Sipariş Kodu / Order Code	d1	L	L1	d2	a	M
U10-1060	10	60	4	12	3	6
80		80				
100		100				
120		120				
140		140				
U10-1260	12	60	7	16	6	6
80		80				
100		100				
120		120				
140		140				
160	160					
U10-1460	14	60	7	18	8	6
80		80				
100		100				
120		120				
140		140				
160	160					
180	180					
U10-1660	16	60	7	20	8	8
80		80				
100		100				
120		120				
140		140				
160		160				
180		180				
200	200					

## U10

### Yağ Kanalsız Şapkalı Kolon Guide Pillar

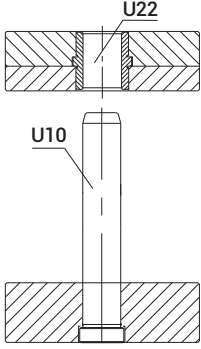

Malzeme / Material  
1.7131 (16MnCr5)

Sertlik / Hardness  
61 - 63 HRC

Isıl İşlem / Heat Treatment

Sementasyon / Case Hardened

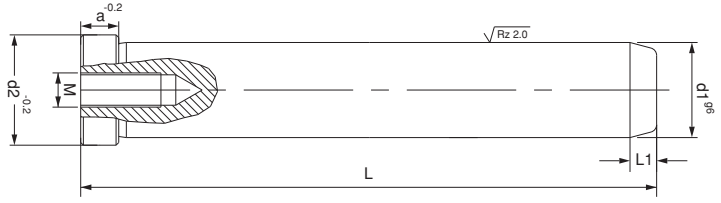

Sipariş Kodu / Order Code	d1	L	L1	d2	a	M
<b>U10-1860</b>	18	60	7	22	8	10
80		80				
100		100				
120		120				
140		140				
160		160				
180		180				
200		200				
240		240				
<b>U10-2060</b>		20				
80	80					
100	100					
120	120					
140	140					
160	160					
180	180					
200	200					
240	240					
300	300					
<b>U10-2280</b>	22	80	7	26	15	10
100		100				
120		120				
140		140				
160		160				
180		180				
200		200				
220		220				
240		240				
300		300				

## U10

### Yağ Kanalsız Şapkalı Kolon Guide Pillar

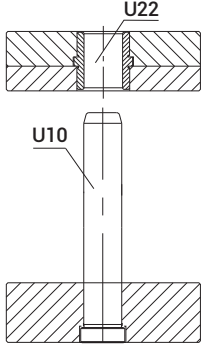

Malzeme / Material  
1.7131 (16MnCr5)

Sertlik / Hardness  
61 - 63 HRC

Isıl İşlem / Heat Treatment

Sementasyon / Case Hardened

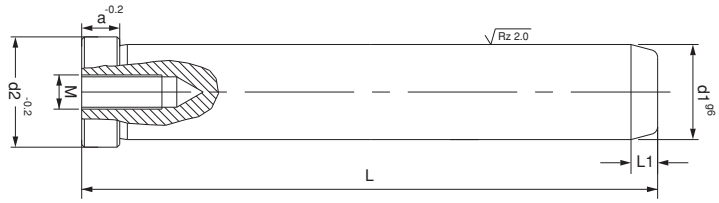

Sipariş Kodu / Order Code	d1	L	L1	d2	a	M
<b>U10-2480</b>	24	80	7	28	15	12
100		100				
120		120				
140		140				
160		160				
180		180				
200		200				
220		220				
240		240				
300		300				
<b>U10-30100</b>	30	100	7	36	15	16
120		120				
140		140				
160		160				
180		180				
200		200				
220		220				
240		240				
300		300				
360		360				
<b>U10-40160</b>	40	160	10	48	15	16
200		200				
240		240				
300		300				
360		360				

## U11

### Alyan Başlı Yağ Kanalsız Kolon

Guide Pillar

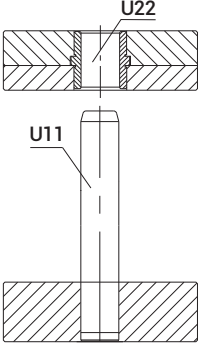

Malzeme / Material  
1.7131 (16MnCr5)

Sertlik / Hardness  
61 - 63 HRC

Isıl İşlem / Heat Treatment

Sementasyon / Case Hardened

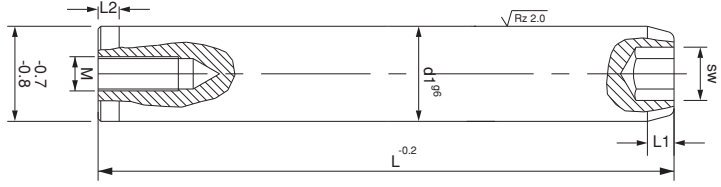

Sipariş Kodu / Order Code	d1	L	L1	L2	sw	M
<b>U11-1260</b>	12	60	7	5	5	6
80		80				
100		100				
120		120				
<b>U11-1460</b>	14	60	7	5	5	6
80		80				
100		100				
<b>U11-1560</b>	15	60	7	5	6	8
80		80				
<b>U11-1680</b>	16	80	7	5,5	6	8
100		100				
120		120				
140		140				
160		160				
<b>U11-1860</b>	18	60	7	6	6	8
80		80				
100		100				
140		140				
170		170				

## U11

### Alyan Başlı Yağ Kanalsız Kolon

Guide Pillar

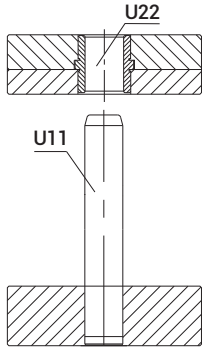

Malzeme / Material  
1.7131 (16MnCr5)

Sertlik / Hardness  
61 - 63 HRC

Isıl İşlem / Heat Treatment

Sementasyon / Case Hardened



U22



U21H



U20

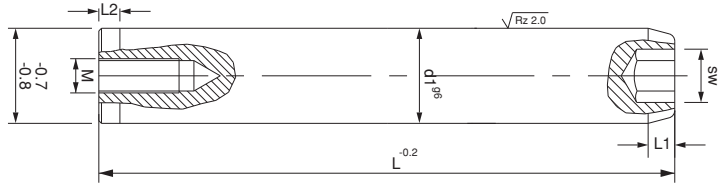

Sipariş Kodu / Order Code	d1	L	L1	L2	sw1	M
U11-2060	20	60	7	7	8	10
80		80				
100		100				
120		120				
140		140				
160		160				
180		180				
210		210				
U11-2280	22	80	7	7	8	10
100		100				
120		120				
U11-2480	24	80	7	7	10	12
100		100				
120		120				
140		140				
160		160				
180		180				
200		200				
220	220					
U11-3080	30	80	7	7	14	16
100		100				
120		120				
140		140				
U11-3280	32	80	7	7	14	16
100		100				
120		120				
140		140				

## U12

### Merkezeleme Burcu

Centering Bush

**Malzeme / Material**  
1.7131 (16MnCr5)

**Sertlik / Hardness**  
61 - 63 HRC

**Isıl İşlem / Heat Treatment**

**Sementasyon / Case Hardened**

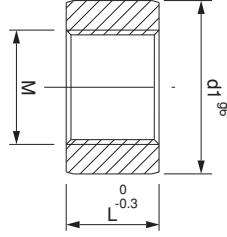

Sipariş Kodu / Order Code	d1	L	M
U12-10 9	10	9	6
U12-12 10	12	10	8
U12-14 11,5	14	11,5	10
U12-16 13,5	16	13,5	12
U12-20 15,5	20	15,5	16
U12-26 17,5	26	17,5	16
U12-30 19,5	30	19,5	20
U12-36 19,5	36	19,5	24
U12-42 19,5	42	19,5	30
U12-54 19,5	54	19,5	36

## U13

### Masuralı Şapkalı Burç

Recirculating  
Guide Bush

Malzeme / Material  
1.7131 (16MnCr5)

Sertlik / Hardness  
61 - 63 HRC

Isıl İşlem / Heat Treatment

Sementasyon / Case Hardened

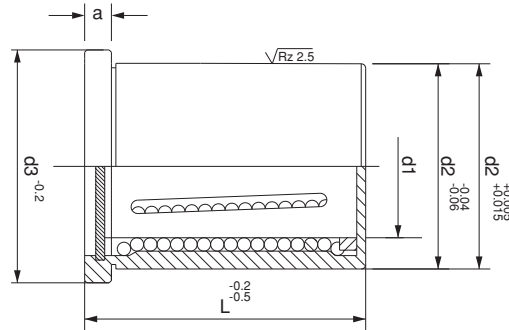

Sipariş Kodu / Order Code	d1	L	d2	d3	a
U13-1835	18	35	30	34	6
U13-2035		35			
45	20	45	32	36	6
55		55			
U13-2435		35			
45	24	45	38	41	6
55		55			
U13-3045		45			
63	30	63	48	54	8
U13-4045		45			
63	40	63	60	66	8

## U20

### Şapkalı Burç

#### Guide Bush

Malzeme / Material  
1.7131 (16MnCr5)

Sertlik / Hardness  
61 - 63 HRC

Isıl İşlem / Heat Treatment

Sementasyon / Case Hardened



**U01**



**U02**

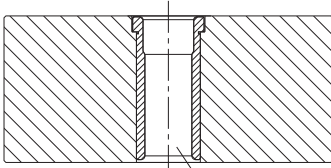

U20

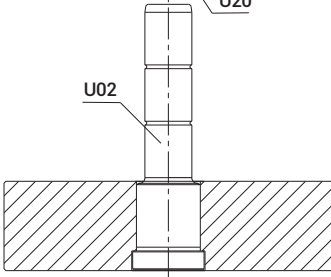

U02

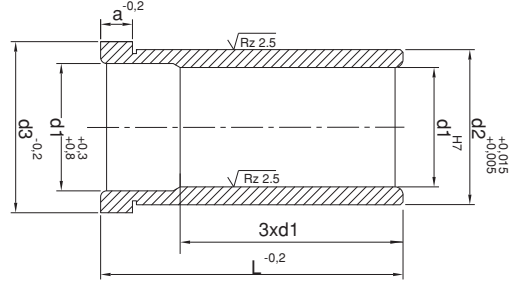

Sipariş Kodu / Order Code	d1	L	d2	d3	a
<b>U20-1226</b>	12	26	16	19	4
36		36			
46		46			
56		56			
66		66			
<b>U20-1426</b>	14	26	20	25	6
36		36			
46		46			
56		56			
66		66			
76	76				
86	86				
<b>U20-1626</b>	16	26	24	28	6
36		36			
46		46			
56		56			
66		66			
76	76				
86	86				



## U20

### Şapkalı Burç

Guide Bush

Malzeme / Material  
1.7131 (16MnCr5)

Sertlik / Hardness  
61 - 63 HRC

Isıl İşlem / Heat Treatment

Sementasyon / Case Hardened

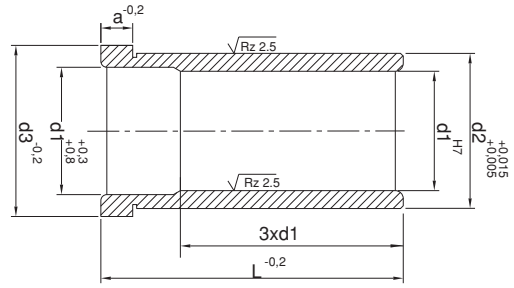
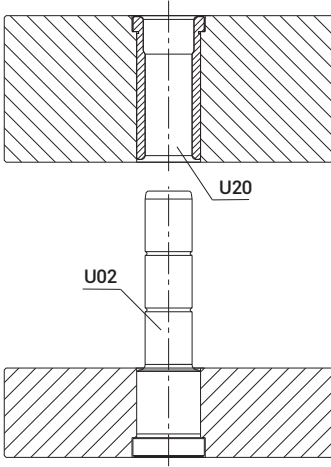

Sipariş Kodu / Order Code	d1	L	d2	d3	a
<b>U20-1826</b>	18	26	26	31	6
36		36			
46		46			
56		56			
66		66			
76		76			
86		86			
<b>U20-2026</b>	20	26	28	32	6
36		36			
46		46			
56		56			
66		66			
76		76			
86		86			
96	96				
<b>U20-2526</b>	25	26	34	38	8
36		36			
46		46			
56		56			
66		66			
76		76			
86		86			
96	96				
106	106				

## U20

### Şapkalı Burç

Guide Bush

Malzeme / Material  
1.7131 (16MnCr5)

Sertlik / Hardness  
61 - 63 HRC

Isıl İşlem / Heat Treatment

Sementasyon / Case Hardened

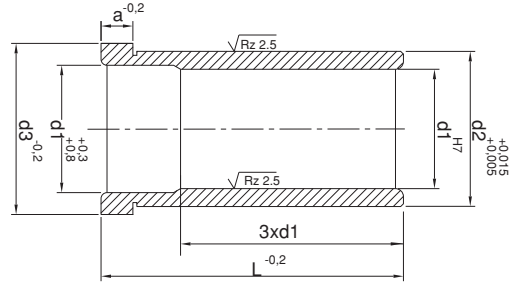
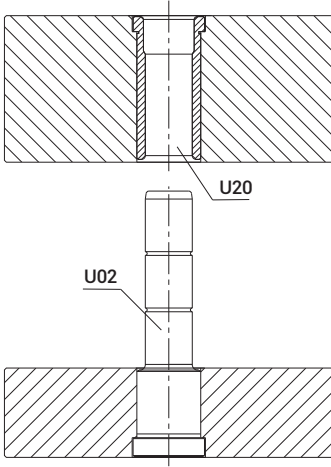

Sipariş Kodu / Order Code	d1	L	d2	d3	a
<b>U20-3036</b>	30	36	39	43	10
46		46			
56		56			
66		66			
76		76			
86		86			
96		96			
106		106			
116		116			
<b>U20-4046</b>	40	46	54	58	10
56		56			
66		66			
76		76			
86		86			
96		96			
106		106			
116		116			
126		126			
136	136				
146	146				

## U21H

### Kuyruklu Şapkalı Burç Tailed Guide Bush

Malzeme / Material  
1.7131 (16MnCr5)

Sertlik / Hardness  
61 - 63 HRC

Isıl İşlem / Heat Treatment

Sementasyon / Case Hardened



U03H



U40H

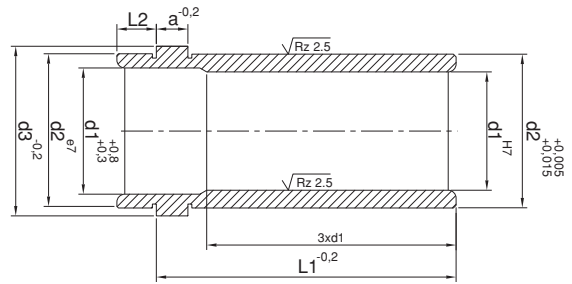
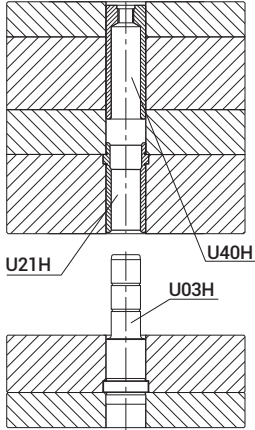

Sip. Kodu / Or. Code	d1	Sip. Kodu / Or. Code	d1	L1	d2	d3	a	L2
<b>U21H-1417</b>	14	<b>U21H-1517</b>	15	17	20	25	6	9
22		22						
27		27						
36		36						
46		46						
56		56						
66		66						
76		76						
86		86						
96		96						
116	116							
<b>U21H-1817</b>	18	<b>U21H-2017</b>	20	17	26	31	6	9
22		22						
27		27						
36		36						
46		46						
56		56						
66		66						
76		76						
86		86						
96		96						
106	106							
116	116							
136	136							

## U21H

### Kuyruklu Şapkalı Burç Tailed Guide Bush

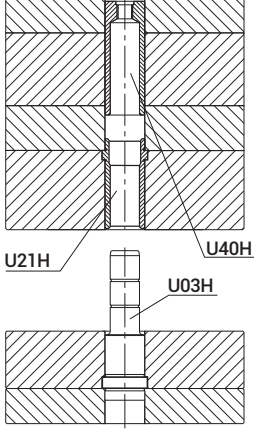

**Malzeme / Material**  
1.7131 (16MnCr5)

**Sertlik / Hardness**  
61 - 63 HRC

**Isıl İşlem / Heat Treatment**

**Sementasyon / Case Hardened**



**U03H**



**U40H**

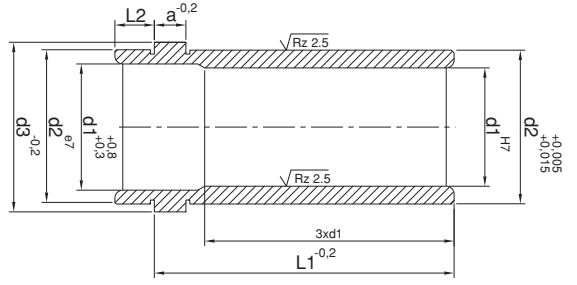

Sip. Kodu / Or. Code	d1	Sip. Kodu / Or. Code	d1	L1	d2	d3	a	L2
<b>U21H-2217</b>	22	<b>U21H-2417</b>	24	17	30	35	6	9
22		22						
27		27						
36		36						
46		46						
56		56						
66		66						
76		76						
86		86						
96		96						
106		106						
116		116						
136		136						
156		156						

## U21H

### Kuyruklu Şapkalı Burç Tailed Guide Bush

Malzeme / Material  
1.7131 (16MnCr5)

Sertlik / Hardness  
61 - 63 HRC

Isıl İşlem / Heat Treatment

Sementasyon / Case Hardened



U03H



U40H

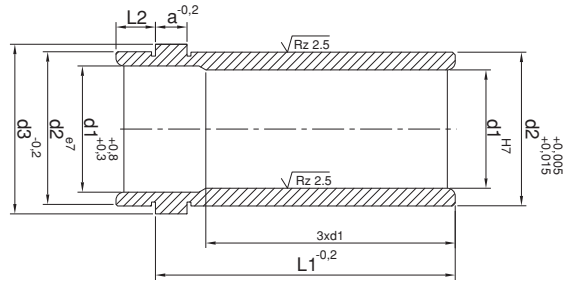
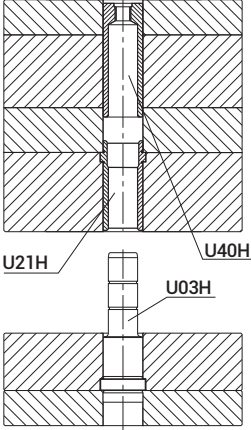

Sip. Kodu / Or. Code	d1	Sip. Kodu / Or. Code	d1	L1	d2	d3	a	L2
<b>U21H-3027</b>	30	<b>U21H-3227</b>	32	27	42	47	6	9
36		36						
46		46						
56		56						
66		66						
76		76						
86		86						
96		96						
106		106						
116		116						
126		126						
136		136						
156		156						
196		196						
<b>U21H-4046</b>	40	<b>U21H-4246</b>	42	46	54	60	10	12
56		56						
66		66						
76		76						
86		86						
96		96						
116		116						
136		136						
156		156						
196		196						
246	246							

## U22

### Ortadan Flanşlı Burç

Middle Flanged Bush

Malzeme / Material  
1.7131 (16MnCr5)

Sertlik / Hardness  
61 - 63 HRC

Isıl İşlem / Heat Treatment

Sementasyon / Case Hardened



U01H



U01

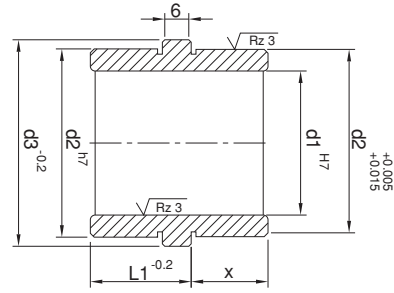
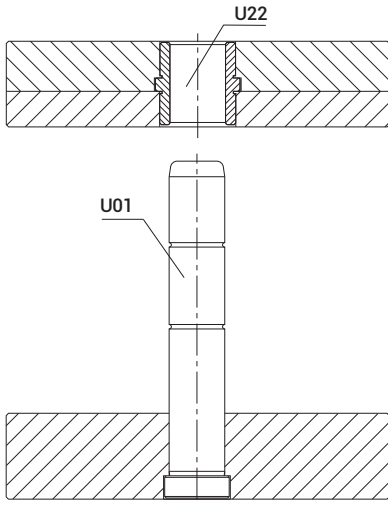

Sipariş Kodu / Order Code	d1	L1	d2	d3	x
U22-1416	14	16	20	25	12
U22-1616	16	16	24	28	12
U22-1816	18	16	26	31	12
U22-2016	20	16	28	32	12
U22-2521	25	21	34	38	16
U22-3021	30	21	39	43	16

## U22B

### Bilyalı Ortadan Flanşlı Burç

Guide Bush with Ball Cage

Malzeme / Material  
1.7131 (16MnCr5)

Sertlik / Hardness  
61 - 63 HRC

Isıl İşlem / Heat Treatment

Sementasyon / Case Hardened

Bilya Malzemesi / Ball Material  
1.3505 (100Cr6)



U08

U09

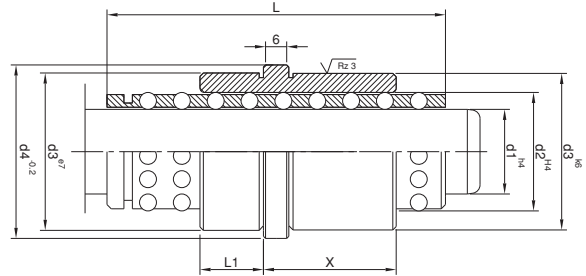
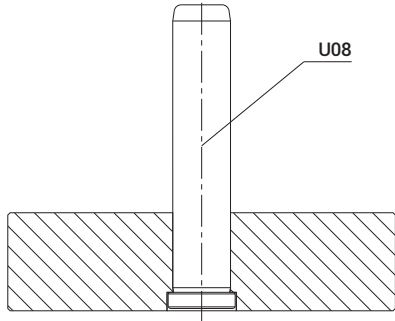
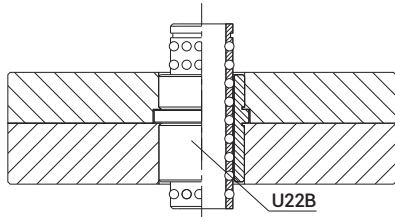

Sipariş Kodu / Order Code	d1	L	L1	d2	d3	d4	x
U22B-1240	12	40	6	16	22	26	18
56		56					
U22B-1845	18	45	11	24	30	35	23
56		56					
71		71					
U22B-3056	30	56	21	38	46	52	33
71		71					
95		95					

## U40H

### Tespit Burcu

### Centring Sleeves

Malzeme / Material  
1.7131 (16MnCr5)

Sertlik / Hardness  
61 - 63 HRC

Isıl İşlem / Heat Treatment

Sementasyon / Case Hardened

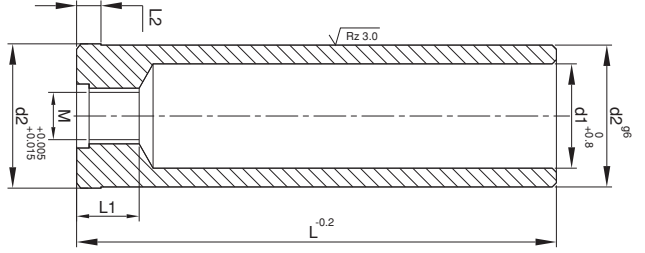
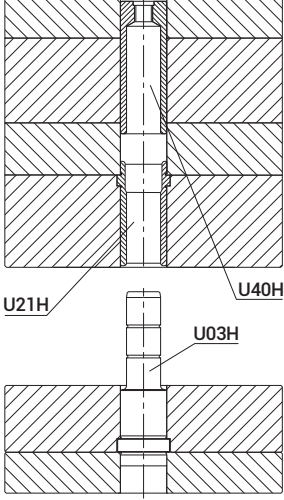

Sipariş Kodu / Order Code	d1	L	d2	M	L1	L2
<b>U40H-2030</b>	16	30	20	12	13	4
40		40				
60		60				
80		80				
100		100				
120		120				
140		140				
<b>U40H-2630</b>		21				
40	40					
60	60					
80	80					
100	100					
120	120					
140	140					
160	160					
<b>U40H-3040</b>	25	40	30	12	13	4
60		60				
80		80				
100		100				
120		120				
140		140				
160		160				
180		180				
200	200					



## U40H

### Tespit Burcu

### Centring Slaves

Malzeme / Material  
1.7131 (16MnCr5)

Sertlik / Hardness

Isıl İşlem / Heat Treatment

Sementasyon / Case Hardened

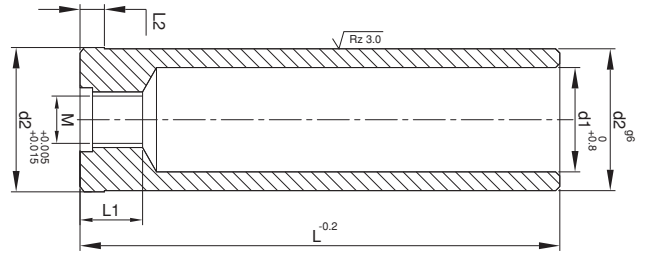
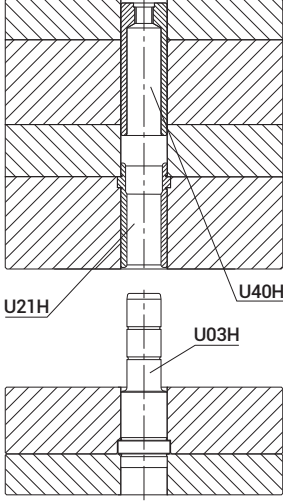

Sipariş Kodu / Order Code	d1	L	d2	M	L1	L2
<b>U40H-4240</b>	33	40	42	12	13	4
60						
80						
100						
120						
140						
160						
180						
200						
220						
<b>U40H-5460</b>	43	60	54	12	16	4
80						
120						
160						
200						
240						

## U50

### Konik Kitleme

#### Locating Unit

**Malzeme / Material**  
1.7131 (16MnCr5)

**Sertlik / Hardness**  
61 - 63 HRC

**Isıl İşlem / Heat Treatment**

**Sementasyon / Case Hardened**

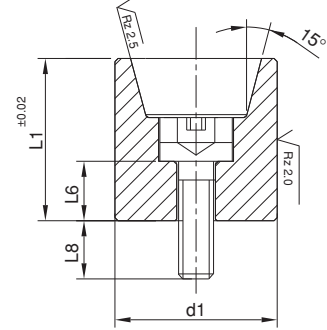
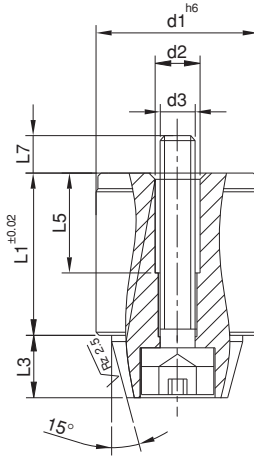
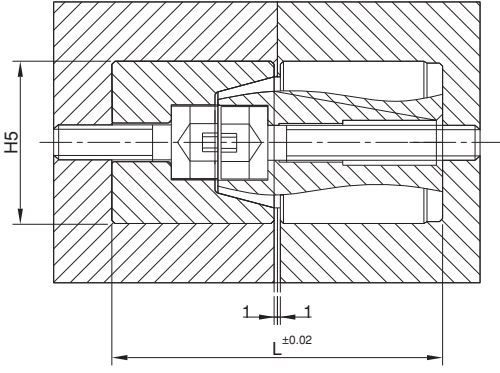

Sip. Kodu / Or. Code	d1	L	L1	L3	L5	L6	L7	L8	d2	d3
U50-12	12	34	16	4.5	9.5	7.0	8	7.5	M4	M3
U50-14	14	34	16	6	12.4	6.0	7.5	8	M5	M4
U50-16	16	34	16	6	12.4	5.8	7.5	8	M5	M4
U50-20	20	54	26	9	19.7	10.6	12	9.5	M8	M6
U50-25	25	54	26	10	19.7	9.2	11	11	M8	M6
U50-30	30	72	35	14	25.0	12.2	15	13	M10	M8
U50-42	42	92	45	18	27.0	16.8	16	13	M10	M8

# U100

## Boynuz Pimi Yatađı

Retainer

**Malzeme / Material**  
1.7131 (16MnCr5)

**Sertlik / Hardness**  
61 - 63 HRC

**Isıl İşlem / Heat Treatment**

**Sementasyon / Case Hardened**



**U06**

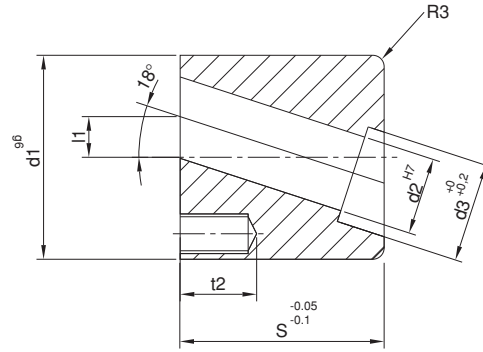
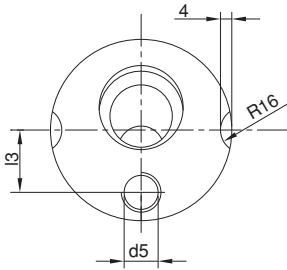

Sipariř Kodu / Order Code	d1	s	d2	d3	d5	l1	l3	t2
U100-12	32	36	12	16	M6	7	10	12
U100-14	36	36	14	18	M8	7	12	16
U100-16	40	46	16	20	M8	8.5	13.5	16
U100-20	45	46	20	25	M8	8.5	15	16
U100-25	50	56	25	29	M8	10	16	16
U100-30	63	66	30	34	M10	12	21	20

# SAC KALIP ÜRÜNLERİ

Punching Mould  
Components



# Sac Kalıp Ürünleri Kombinasyon Şeması

## Punching Mould Components Combination Chart

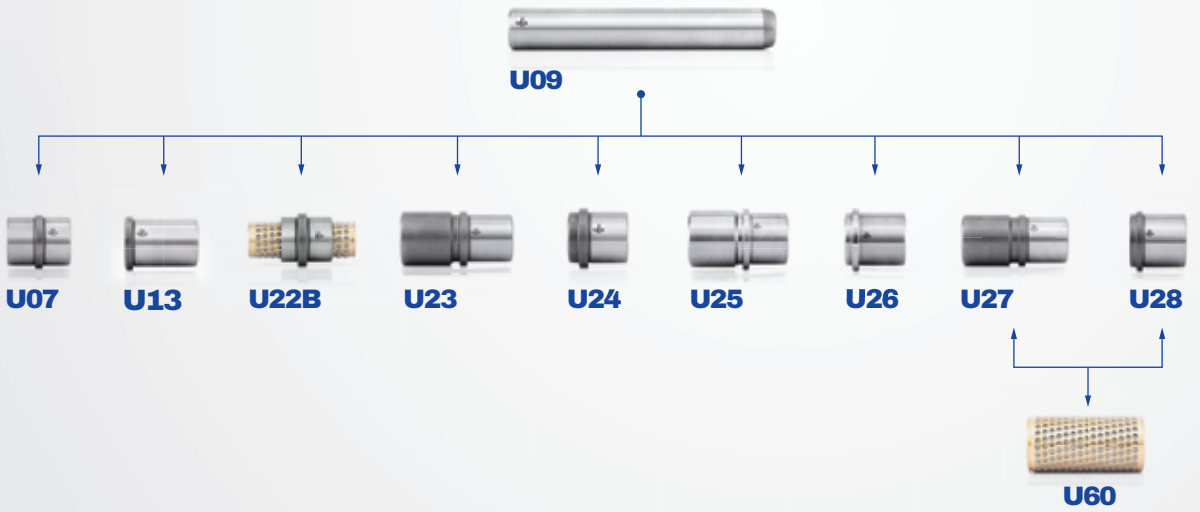
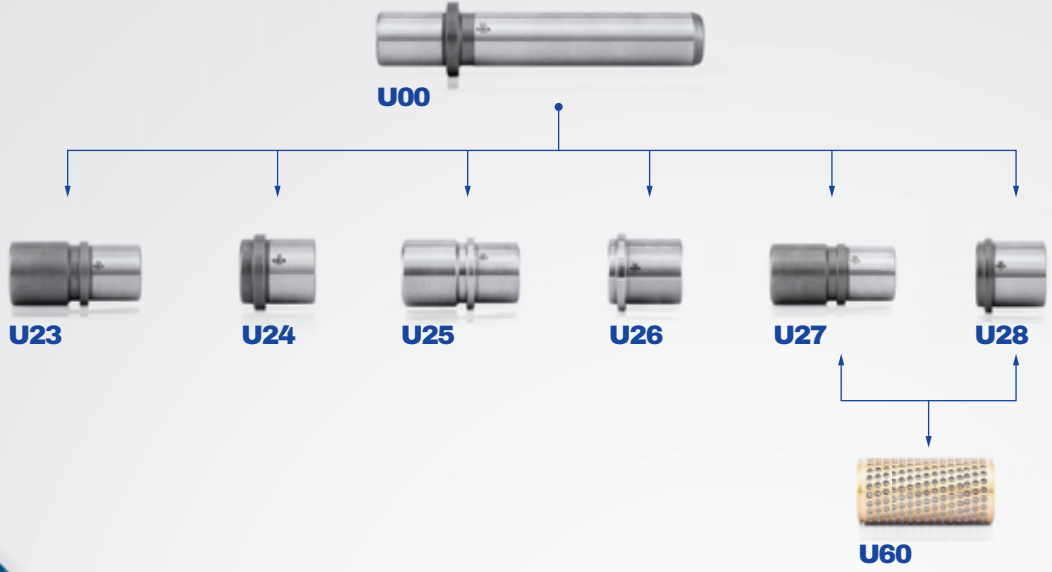

## U00

### Ortadan Şapkalı Kolon

#### Guide Pillar

Malzeme / Material  
1.1213 (CF53)

Sertlik / Hardness  
61 - 63 HRC

Isıl İşlem / Heat Treatment

İndüksiyon Sertleştirme  
Induction Hardening

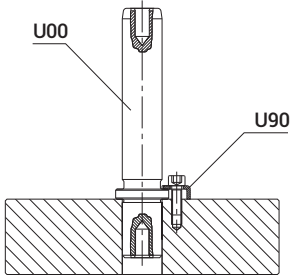
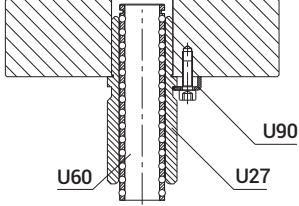

U23



U24



U25



U26



U27



U28



U60

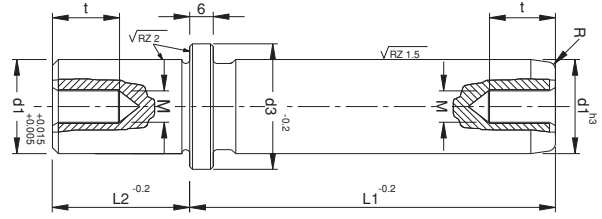

Sipariş Kodu / Order Code	d1	L1	L2	d3	t	R	M
<b>U00-1610020</b>	16	100	20	22	20	3	6
11220		112					
12520		125					
14020		140					
16020		160					
18020		180					
20020		200					
<b>U00-2010023</b>	20	100	23	25	20	3	8
11223		112					
12523		125					
14023		140					
16023		160					
18023		180					
20023	200						
<b>U00-2510030</b>	25	100	30	32	20	5	8
11230		112					
12530		125					
14030		140					
16030		160					
18030		180					
20030		200					
22430		224					
25030	250						

# U00

## Ortadan Şapkalı Kolon Guide Pillar

Malzeme / Material  
1.1213 (CF53)

Sertlik / Hardness  
61 - 63 HRC

Isıl İşlem / Heat Treatment

İndüksiyon Sertleştirme  
Induction Hardening

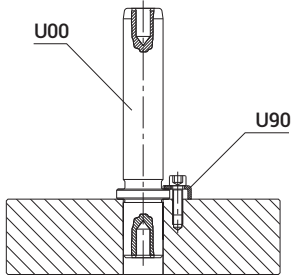
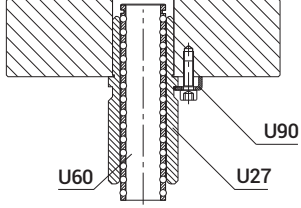

U23



U24



U25



U26



U27



U28



U60

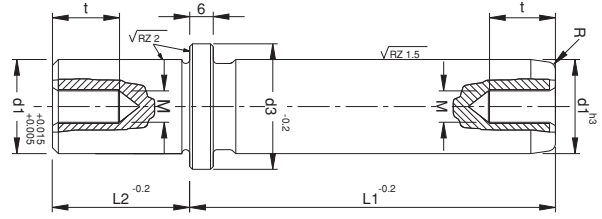

Sipariş Kodu / Order Code	d1	L1	L2	d3	t	R	M
U00-3011237	30	112	37	40	20	5	8
12537		125					
14037		140					
16037		160					
18037		180					
20037		200					
22437		224					
25037		250					
28037		280					
31537		315					
U00-3211237	32	112	37	40	20	5	8
12537		125					
14037		140					
16037		160					
18037		180					
20037		200					
22437		224					
25037		250					
28037		280					
31537		315					

## U00

### Ortadan Şapkalı Kolon Guide Pillar

**Malzeme / Material**  
1.1213 (CF53)

**Sertlik / Hardness**  
61 - 63 HRC

**Isıl İşlem / Heat Treatment**

**İndüksiyon Sertleştirme**  
Induction Hardening

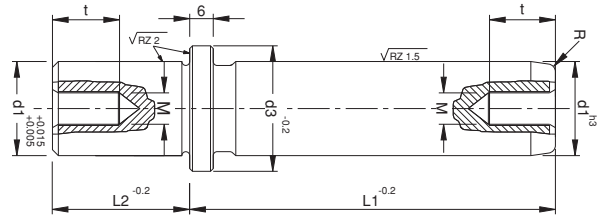
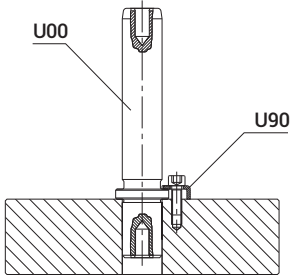
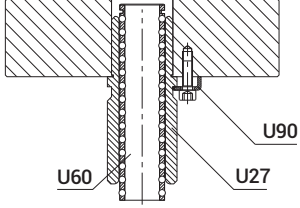

Sipariş Kodu / Order Code	d1	L1	L2	d3	t	R	M
<b>U00-4012537</b>	40	125	37	50	20	5	8
14037		140					
16037		160					
18037		180					
20037		200					
22437		224					
25037		250					
28037		280					
31537		315					
35537		355					
<b>U00-5014047</b>		50					
16047	160						
18047	180						
20047	200						
22447	224						
25047	250						
28047	280						
31547	315						
35547	355						
40047	400						



# U00

## Ortadan Şapkalı Kolon

### Guide Pillar

**Malzeme / Material**  
1.1213 (CF53)

**Sertlik / Hardness**  
61 - 63 HRC

**Isıl İşlem / Heat Treatment**

**İndüksiyon Sertleştirme**  
Induction Hardening

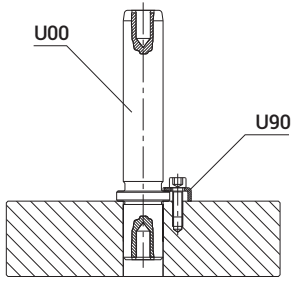
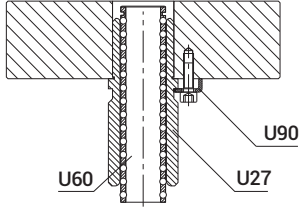

**U23**



**U24**



**U25**



**U26**



**U27**



**U28**



**U60**

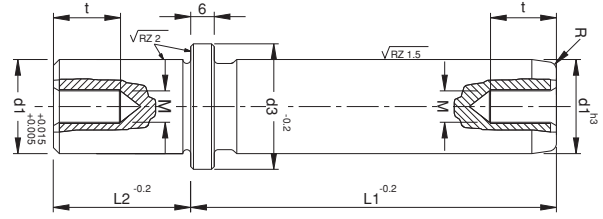

Sipariş Kodu / Order Code	d1	L1	L2	d3	t	R	M
<b>U00-6316047</b>		<b>160</b>					
<b>18047</b>		<b>180</b>					
<b>20047</b>		<b>200</b>					
<b>22447</b>		<b>224</b>					
<b>25047</b>	<b>63</b>	<b>250</b>	<b>47</b>	<b>80</b>	<b>20</b>	<b>5</b>	<b>8</b>
<b>28047</b>		<b>280</b>					
<b>31547</b>		<b>315</b>					
<b>35547</b>		<b>355</b>					
<b>40047</b>		<b>400</b>					

• Ø80 siparişe göre üretilir. / Ø80 available on customer request

## U09

### Düz Kolon Guide Pillar

**Malzeme / Material**  
1.1213 (CF53)

**Sertlik / Hardness**  
61 - 63 HRC

**Isıl İşlem / Heat Treatment**

**İndüksiyon Sertleştirme**  
Induction Hardening

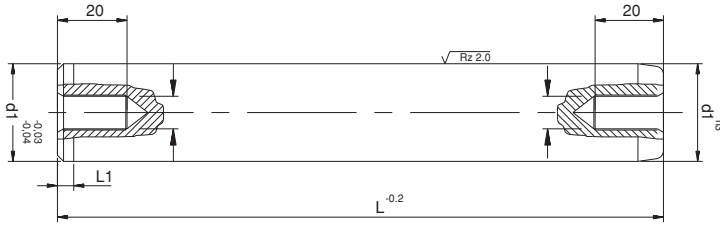

Sipariş Kodu / Order Code	d1	L	L1	M
<b>U09-1280</b>		<b>80</b>		
100		100		
120	12	120	3	5
140		140		
160		160		
<b>U09-1880</b>		<b>80</b>		
100		100		
120	18	120	3	5
140		140		
160		160		
180		180		
<b>U09-20100</b>		<b>100</b>		
112		112		
125		125		
140	20	140	4	8
160		160		
180		180		
200		200		
224		224		

## U09

### Düz Kolon

### Guide Pillar

**Malzeme / Material**  
1.1213 (CF53)

**Sertlik / Hardness**  
61 - 63 HRC

**Isıl İşlem / Heat Treatment**

**İndüksiyon Sertleştirme**  
Induction Hardening

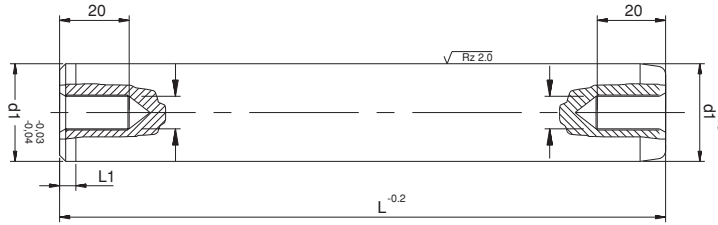

Sipariş Kodu / Order Code	d1	L	L1	M
<b>U09-24100</b>	24	100	4	8
120		120		
140		140		
160		160		
180		180		
200		200		
<b>U09-25112</b>	25	112	4	8
125		125		
140		140		
160		160		
180		180		
200		200		
224		224		
250	250			
280	280			
<b>U09-30140</b>	30	140	4	8
160		160		
180		180		
200		200		
224		224		
250		250		
280		280		
315	315			

## U09

### Düz Kolon Guide Pillar

**Malzeme / Material**  
1.1213 (CF53)

**Sertlik / Hardness**  
61 - 63 HRC

**Isıl İşlem / Heat Treatment**

**İndüksiyon Sertleştirme**  
Induction Hardening

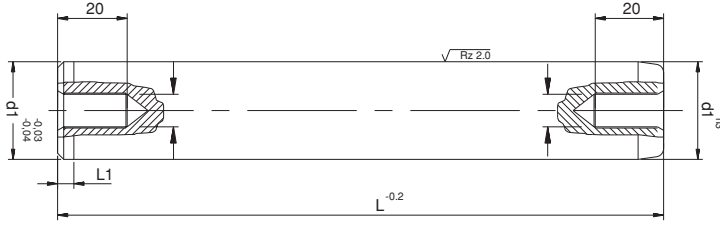

Sipariş Kodu / Order Code	d1	L	L1	M
<b>U09-40160</b>	40	160	4	8
180		180		
200		200		
224		224		
250		250		
280		280		
315		315		
355		355		
400		400		
<b>U09-50180</b>		50		
200	200			
224	224			
250	250			
280	280			
315	315			
355	355			
400	400			
500	500			
<b>U09-63280</b>	63	280	5	12
315		315		
355		355		
400		400		

• Ø63 siparişe göre üretilir. / Ø63 available on customer request

## U23

### Ortadan Şapkalı Burç Guide Bush

Malzeme / Material  
1.7131 (16MnCr5)

Sertlik / Hardness  
61 - 63 HRC

Isıl İşlem / Heat Treatment

Sementasyon / Case Hardened

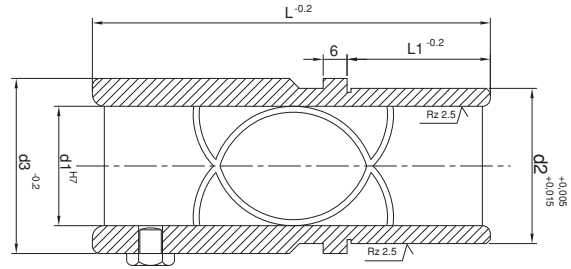
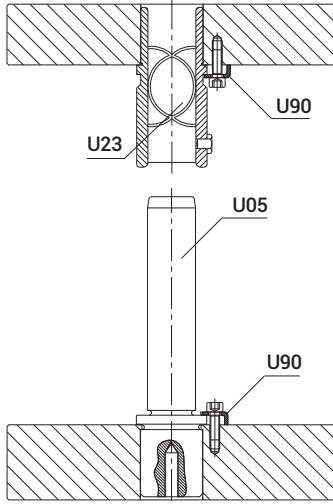

Sipariş Kodu / Order Code	d1	L	L1	d2	d3
U23-207026	20	70	26	28	34
7036		70	36		
U23-258026	25	80	26	34	39
8036		80	36		
U23-309036	30	90	36	39	44
9046		90	46		
U23-4010036	40	100	36	50	54
10836		108	36	58	65
10046		100	46	50	54
U23-5012046	50	120	46	60	64
12056		120	56	60	64
12756		127	56	70	75
U23-6313056	63	130	56	85	95
15056		150	56		

## U24

### Üstten Şapkalı Burç Guide Bush

Malzeme / Material  
1.7131 (16MnCr5)

Sertlik / Hardness  
61 - 63 HRC

Isıl İşlem / Heat Treatment

Sementasyon / Case Hardened

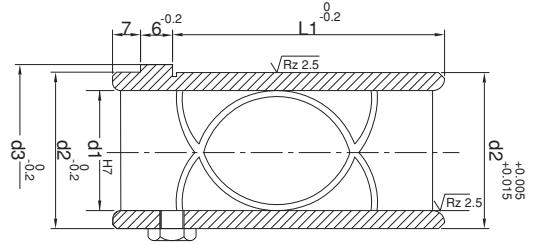
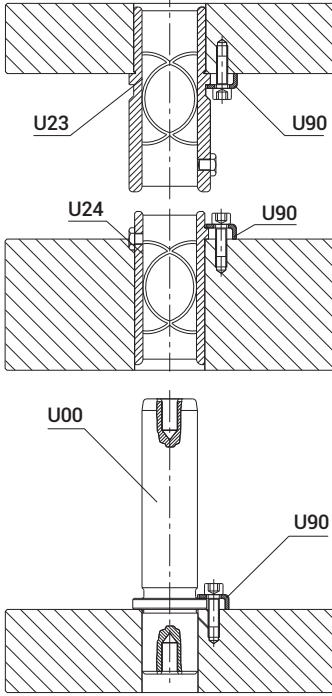

Sipariş Kodu / Order Code	d1	d2	L1	d3
U24-202826	20	28	26	34
U24-253426	25	34	26	39
3436			36	
U24-303926	30	39	26	44
3936			36	
U24-405036	40	50	36	54
5046		50	46	54
5846		58	46	65
U24-506046	50	60	46	64
6056		60	56	64
7046		70	46	75
U24-638546	63	85	46	95
8556			56	

## U25

### Uzun Bronz Geçmeli Burç

Guide Bush  
With Bronze

Malzeme / Material  
CK50(1050) - CUSN12 (BRONZ)

Sertlik / Hardness  
58 - 62 HRC

Isıl İşlem / Heat Treatment

İndüksiyon Sertleştirme  
Induction Hardening

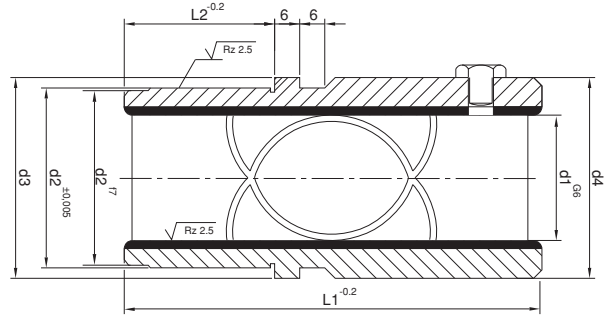
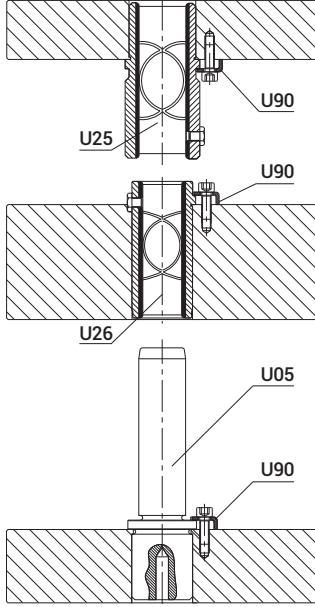

Sipariş Kodu / Order Code	d1	L1	L2	d2	d3	d4
<b>U25-204323</b>		<b>43</b>	<b>23</b>			
5923	20	59	23	32	40	39
5933		59	33			
<b>U25-255923</b>		<b>59</b>	<b>23</b>			
7923	25	79	23	40	48	46
7933		79	33			
<b>U25-307530</b>		<b>75</b>	<b>30</b>			
9330	30	93	30	48	55	53
9340		93	40			
<b>U25-327530</b>		<b>75</b>	<b>30</b>			
9330	32	93	30	48	55	53
9340		93	40			
<b>U25-408237</b>		<b>82</b>	<b>37</b>			
10837	40	108	37	58	65	63
10847		108	47			
<b>U25-509747</b>		<b>97</b>	<b>47</b>			
12747	50	127	47	70	80	77
12757		127	57			
<b>U25-6311660</b>		<b>116</b>	<b>60</b>			
15060	63	150	60	85	95	92

## U26

### Kısa Bronz Geçmeli Burç Guide Bush With Bronze

**Malzeme / Material**  
CK50(1050) - CUSN12 (BRONZ)

**Sertlik / Hardness**  
58 - 62 HRC

**Isıl İşlem / Heat Treatment**

**İndüksiyon Sertleştirme**  
Induction Hardening

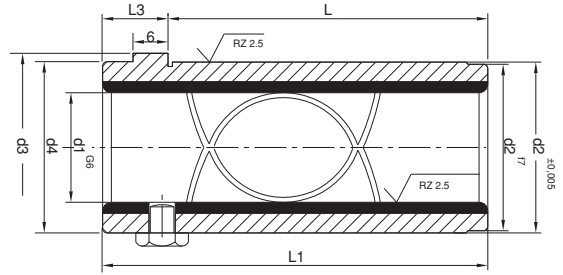
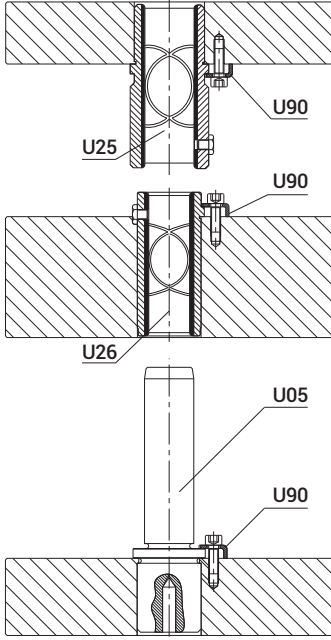

Sipariş Kodu / Order Code	d1	L1	L2	d2	d3	d4	L3
<b>U26-203523</b>	20	35	23	32	40	32	12
4533		45	33				
<b>U26-253523</b>	25	35	23	40	48	40	12
4533		45	33				
<b>U26-304230</b>	30	42	30	48	55	48	12
5240		52	40				
<b>U26-324230</b>	32	42	30	48	55	48	12
5240		52	40				
<b>U26-405237</b>	40	52	37	58	65	58	15
6247		62	47				
<b>U26-506547</b>	50	65	47	70	80	70	18
7557		75	57				
<b>U26-638060</b>	63	80	60	85	93	91	20



## U27

### Şapkalı Bilyalı Burç Guide Bush

Malzeme / Material  
1.7131 (16MnCr5)  
Sertlik / Hardness  
61 - 63 HRC  
Isıl İşlem / Heat Treatment  
Sementasyon / Case Hardened



U60



U09



U00

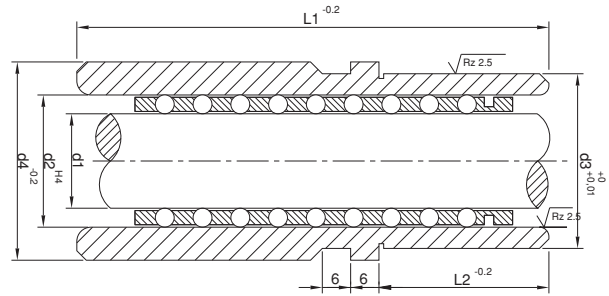
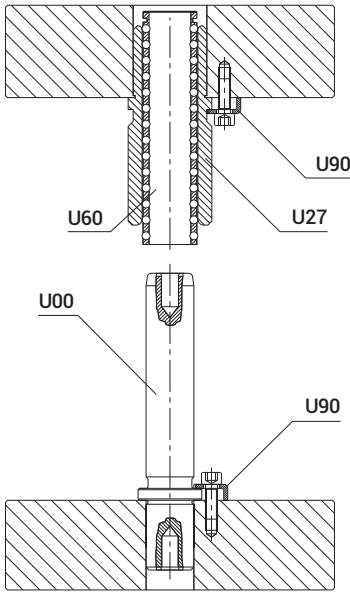

Sipariş Kodu / Order Code	d1	L1	L2	d2	d3	d4
U27-167026	16	70	26	22	30	34
7036			36			
U27-208026	20	80	26	26	34	39
8036			36			
U27-259026	25	90	26	31	40	44
9036			36			
U27-3010036	30	100	36	38	48	54
10046			46			
U27-408236	40	112	82	48	58	64
11236			36			
11246			46			
U27-509746	50	130	97	58	70	79
13046			46			
13056			56			
U27-6311660	63	150	116	71	85	95
15060			60			

## U28

### Kısa Bilyalı Burç Guide Bush

Malzeme / Material  
1.7131 (16MnCr5)

Sertlik / Hardness  
61 - 63 HRC

Isıl İşlem / Heat Treatment

Sementasyon / Case Hardened



U60



U09



U00

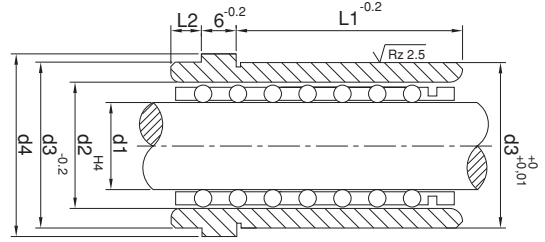
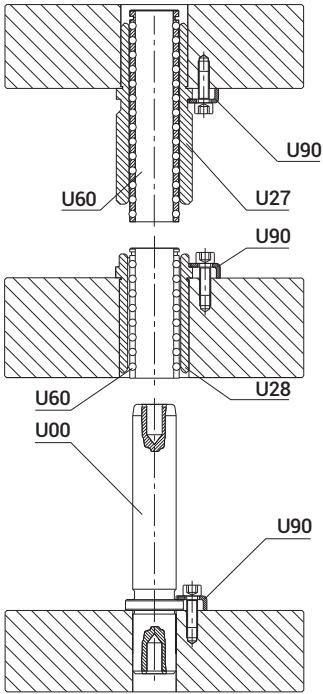

Sipariş Kodu / Order Code	d1	L1	L2	d2	d3	d4
U28-1626 36	16	26 36	7	22	30	34
U28-2026 36	20	26 36	7	26	34	39
U28-2526 36	25	26 36	7	31	40	44
U28-3036 46	30	36 46	7	38	48	54
U28-4036 46	40	36 46	7	48	58	64
U28-5046 56	50	46 56	7	58	70	79
U28-638060	63	60	14	71	85	95

# U60

## Bilyalı Burç

### Guide Bush

Malzeme / Metarial  
MS 58

Bilya Malzemesi / Ball Metarial  
1.3505 (100Cr6)

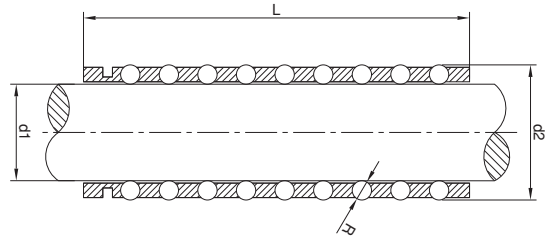
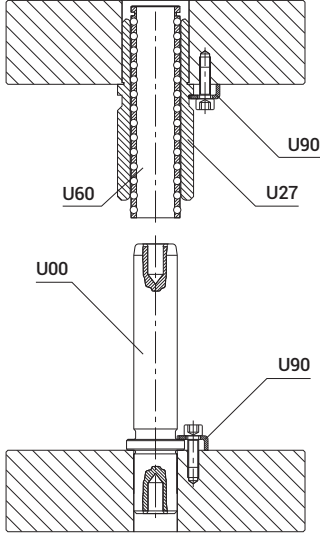
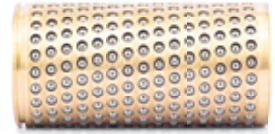

\*n: misket adeti  
\*n: number of balls

Sipariş Kodu / Order Code	d1	L	d2	R	n
<b>U60-1645</b>	16	45	22	3	140
56		56			196
71		71			238
<b>U60-2045</b>	20	45	26	3	180
56		56			234
71		71			306
80		80			342
95		95			414
<b>U60-2545</b>	25	45	31	3	180
56		56			240
71		71			280
80		80			320
95		95			440
105		105			480
120	120	560			
<b>U60-3045</b>	30	45	38	4	140
56		56			180
71		71			240
80		80			280
95		95			340
105		105			380
120		120			420
140	140	500			

## U60

### Bilyalı Burç

#### Guide Bush

Malzeme / Material  
MS 58

Bilya Malzemesi / Ball Material  
1.3505 (100Cr6)

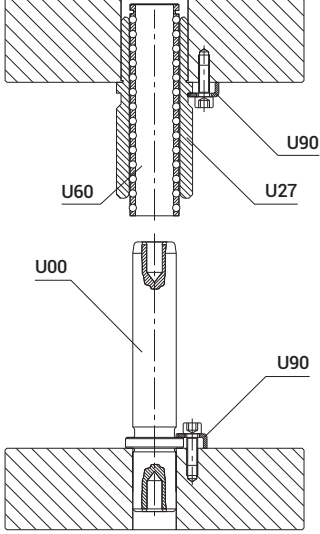

U00



U09



U27



U28

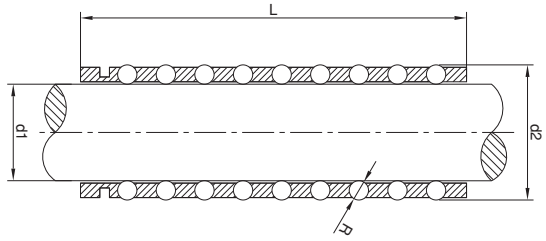

\*n: misket adeti  
\*n: number of balls

Sipariş Kodu / Order Code	d1	L	d2	R	*n
<b>U60-4056</b>	40	56	48	4	216
71		71			288
80		80			336
95		95			408
105		105			456
120		120			528
140		140			624
160		160			720
<b>U60-5071</b>	50	71	58	4	360
80		80			390
95		95			480
105		105			540
120		120			600
160		160			840
<b>U60-6385</b>	63	85	71	4	504
95		95			558
105		105			612
120		120			720
160		160			972

## U90

**Bağlama Pabucu**  
Pillar & Bush Clamp

Sertlik / Hardness  
40 - 42 HRC



**A-A KESİTİ**

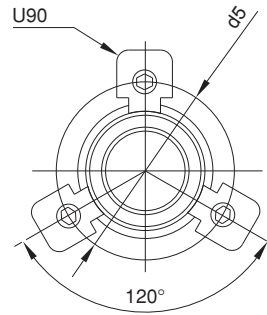
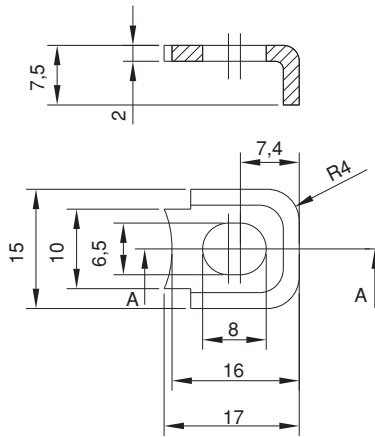



**K UKS**  
KALIP ELEMANLARI  
MOLD COMPONENTS

The right choice  
of the mold maker

UKS

UKS KALIP ELEMANLARI



**UKS**

**KALIP ELEMENLARI**  
**MOLD COMPONENTS**



Turkey



USA



Holland



Belgium



Germany



Italy



Austria



Czech  
Republic



Jordan

**K**  
**UKS**  
KALIP ELEMANLARI  
MOLD COMPONENTS

Akçaburgaz Mh. 3038 Sk.  
No:18 34538 Esenyurt  
İstanbul / TURKEY  
P: +90 212 485 32 58

info@ugurkalip.com.tr  
www.uk.com.tr

